

# Automata

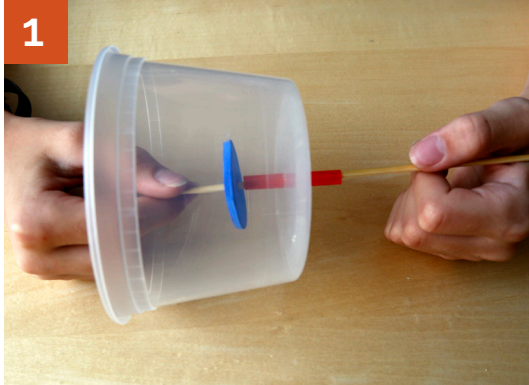

# Automata



## Build a cam system.

Turn a plastic container upside down. Insert a piece of straw into the hole on the top and tape it into place. Thread a skewer through the straw, then push it through the middle of a foam circle.

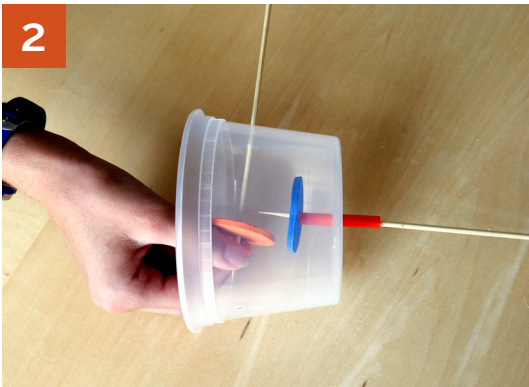

Insert a skewer through the hole in the side of the container. Push the skewer through the center of a second foam circle and out the hole in the other side of the container.

Adjust the foam circles so they are at right angles, with the flat surface of the top one resting on the edge of the bottom one.



## Bring it to life!

Now decorate your automaton. You can put whatever you want on top. Turn the handle.

*Is it alive?*

*How can you tell the difference between a machine and a living creature?*