

NISE Network Earth & Space Partner Meeting

*Arizona State University
February 13–15, 2019*



Welcome

The National Informal STEM Education Network (NISE Network) is a community of informal educators and scientists dedicated to supporting learning about science, technology, engineering, and math (STEM) across the United States. The NISE Network community encourages STEM learning opportunities across the United States by bringing cutting-edge research to museum exhibits and programs, improving the practices of educators and scientists, and creating lasting, valuable relationships among individuals and organizations.

Meeting Goals

1. Participants will identify ways they can enhance their public engagement efforts related to Earth and space science by using NISE Network and NASA Science Activation products and resources.
2. Participants will increase their knowledge of Earth and space science content and develop skills related to informal STEM education.
3. Participants will learn strategies and opportunities to increase local collaborations with other organizations and with Earth and space science subject matter experts.
4. Participants will understand the goals, impact, and learnings of NISE Net's Earth & Space project and feel motivated to continue and increase their project-related work.



NISE Network Earth & Space Partner Meeting

*Arizona State University
February 13–15, 2019*

Contents

Travel	4
On Your Own	5
ASU Campus Map	6
Conference Center Map	7
Agenda: Snapshot	8
Agenda: Full	9
Featured Speakers	12
Concurrent Sessions	14
Showcase	17
Regional Hub Map	22
Participant Lists	23

Travel

MEETING HOTELS:

Tempe Mission Palms Hotel and Conference Center

(Meeting venue)

60 E 5th St, Tempe, AZ 85281

www.destinationhotels.com/tempe-mission-palms

480.894.1400

Residence Inn by Marriott Tempe

Downtown/University

510 S Forest Ave, Tempe, AZ 85281

www.marriott.com/hotels/travel/phxtd-residence-inn-tempe-downtown-university

480.967.2300

TRANSPORTATION:

Tempe Mission Palms Hotel shuttle

Complimentary airport shuttle service is available between 5:30am and 10:00pm for the 10-minute or so ride to the hotel. After arriving at Sky Harbor Airport, please pick up your luggage at baggage claim, if needed, and call the Tempe Mission Palms Operator at 480.894.1400 to inform them of your terminal number. The hotel will provide directions on where to wait. Hotel vans are white with the hotel logo. Shuttles should arrive within 20 minutes. We will coordinate return shuttle service to the airport following the conclusion of the meeting. You can also arrange for this service at the front desk.

Taxi and ridesharing

Lyft, Uber, and other rideshare services are available at the Phoenix Sky Harbor Airport and in Tempe with service throughout the valley. Also, here is a list of recommended taxicab services:

Campus Cab 480.232.4511

Tempe Taxi Co. 480.406.5030

AZ Taxi Cab Co. 480.332.1192

Light rail

The valley's light rail system connects downtown Tempe with Sky Harbor Airport, downtown Phoenix, and west Mesa. The light rail stop closest to the meeting hotels is at Third Street and Mill Avenue. More information is available: www.valleymetro.org

Bus

Tempe's FLASH shuttle system runs Mon–Fri, 6:45 am–1:00 am, with buses every 10–15 min stopping at points around the periphery of the ASU campus. For a route map, visit: www.valleymetro.org/maps-schedules/flsh

The Orbit “Free Circulator Neighborhood” shuttle system runs more extensively throughout Tempe daily. Many of the routes come within a short walking distance to the meeting hotel at the “Tempe Transportation Center.” A map showing the (appropriately named planetary!) routes can be found here: www.tempe.gov/home/showdocument?id=63756

Parking

Guests staying at the hotel may use the complimentary valet parking. Local attendees not staying at the hotel will be provided a code for metered parking.



On Your Own

TEMPE

ASU Meteorite Gallery

781 E. Terrace Road (ISTB4 Building, 2nd Floor)
Monday–Friday, 9am–5pm, self-guided
Admission: free
www.meteorites.asu.edu/visit
480.727.6625

20-minute walk from hotels

ASU Art Museum at Nelson Fine Arts Center

51 E. 10th Street
(SE Corner of Mill Avenue and 10th Street)
Tuesday–Saturday, 11am–5pm,
Thursday, 11am–8pm
Admission: free
www.asuartmuseum.asu.edu/visit
480.965.2787

15-minute walk from hotels

Tempe Center for the Arts

700 W. Rio Salado Parkway
Tuesday–Thursday, 10am–6pm,
Friday and Saturday, 11am–7:30pm
Gallery admission: free
www.tempecenterforthearts.com/visit
480.350.5679

20-minute walk from hotels

Discount Lyft code: TCAFE8

PHOENIX

Arizona Science Center

600 E. Washington Street, Phoenix, AZ 85004
Monday–Sunday, 10am–5pm
Admission: \$18 adults, ASTC members free
www.azscience.org/visit
602.716.2000

Please note that the NISE Network *Sun, Earth, Universe* exhibition is currently on display!

Children’s Museum of Phoenix

215 N 7th Street, Phoenix, AZ 85034
Monday–Sunday, 9am–4pm
Admission: \$15 non-members
www.childrensmuseumofphoenix.org
602.253.0501

Desert Botanical Garden

1201 N. Galvin Parkway, Phoenix, AZ 85008
Monday–Sunday, 8am–10pm or 11pm
Admission: \$25 non-members
www.dbg.org
480.941.1225

MESA

Arizona Museum of Natural History

53 N. Macdonald, Mesa, AZ 85201
Tuesday–Saturday, 10am–5pm
Admission: \$12 adults
www.arizonamuseumofnaturalhistory.org
480.644.2230

i.d.e.a. Museum

150 W. Pepper Place, Mesa, AZ 85201
Tuesday–Thursday, 10am–4pm,
Friday–Saturday, 10am–6pm
Admission: \$9 adults, 50% discount for ACM members
www.ideamuseum.org
480.644.2468

BEYOND THE VALLEY

Meteor Crater (Winslow)

about a 3-hour drive from Tempe
www.meteorcrater.com

Lowell Observatory (Flagstaff)

about a 2.5-hour drive from Tempe
www.lowell.edu

Kitt Peak Visitor Center (Tucson)

about a 2.5-hour drive from Tempe
www.noao.edu/kpvc/Prog

Oak Creek Canyon hiking (Sedona)

about a 2.25-hour drive from Tempe
www.hikesedona.com/most-popular-hiking-trails

ASU Campus Map



Conference Center Map

FIRST FLOOR

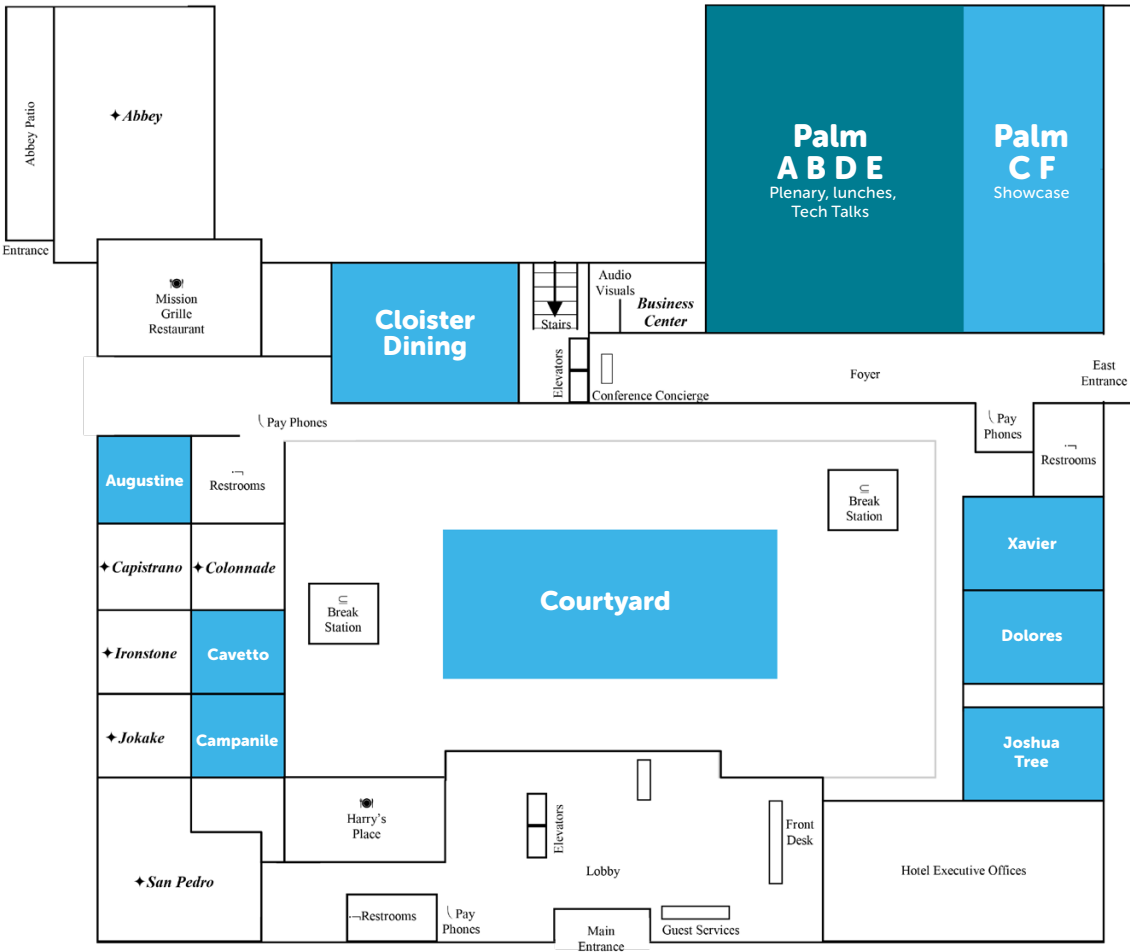

SECOND FLOOR

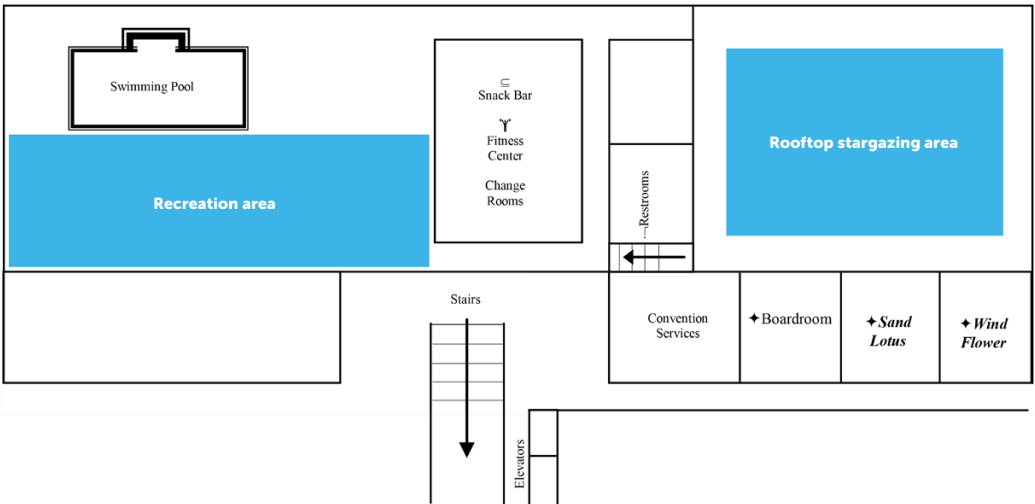

Agenda: Snapshot

	WEDNESDAY FEB 13	THURSDAY FEB 14	FRIDAY FEB 15
8:00 AM		Breakfast (Cloister Dining)	Breakfast (Cloister Dining)
8:30 AM		PLENARY Welcome, Introduction <i>Kristen Erickson</i> (Palm ABDE)	Welcome, Charge for the Day (Palm ABDE)
9:00 AM		PLENARY <i>Jim Bell</i>	PLENARY Big Stories
9:30 AM			
10:00 AM		Break	Break
10:30 AM			
11:00 AM		CONCURRENT SESSION A	CONCURRENT SESSION C
11:30 AM			
12:00 PM	Showcase setup (Palm CF)	Lunch served (Cloister Dining)	Lunch served (Cloister Dining)
12:15 PM			
12:30 PM		REGIONAL HUB MEETINGS (eat lunch in Palm ABDE)	LUNCH PLENARY (eat lunch in Palm ABDE)
1:00 PM		Break	Meeting concludes
1:30 PM			
1:45 PM		CONCURRENT SESSION B	
2:00 PM			
2:30 PM			
3:00 PM	Registration open (Palm Ballroom Foyer)	Break	
3:30 PM		NASA SCIENCE ACTIVATION SHOWCASE (Palm CF) and technology talks (Palm ABDE)	
5:00 PM		Break GROUP PHOTO AT 5:55 (courtyard)	
6:00 PM	Dinner served (Palm Ballroom)	Dinner served (Palm Ballroom)	
6:30 PM	DINNER PLENARY <i>Lindy Elkins-Tanton</i>	DINNER PLENARY <i>Ed Finn</i>	
7:45 PM	Networking reception and mixer (Courtyard)	Networking reception and mixer (2nd Floor recreation area)	
		Telescope viewing (Roof area)	

Agenda: Full

WEDNESDAY, FEBRUARY 13

Tempe Mission Palms Hotel, Plenaries in Palm Ballroom ABDE

- 3:00 – 6:00 pm Registration open, Palm Ballroom Foyer
- 6:00 – 6:30 pm Dinner served, Palm Ballroom
- 6:30 – 7:45 pm **DINNER PLENARY**
Paul Martin, *School for the Future of Innovation in Society, ASU*
David Guston, *School for the Future of Innovation in Society, ASU*
Lindy Elkins-Tanton, *School of Earth and Space Exploration, ASU*
Space Initiatives at ASU
- 7:45 – 9:00 pm Networking reception and mixer, Courtyard

THURSDAY, FEBRUARY 14

Tempe Mission Palms Hotel, Plenaries in Palm Ballroom ABDE

- 8:00 – 8:30 am Breakfast, Cloister Dining
- 8:00 am – 3:00 pm Showcase setup time (for showcase presenters only), Palm CF
- 8:30 – 9:00 am **PLENARY**
Welcome and Introduction
Kristen Erickson, *NASA, Science Mission Directorate*
- 9:00 – 10:30 am **PLENARY**
Jim Bell, *School of Earth and Space Exploration, ASU*
The Ultimate Interplanetary Travel Guide: A Futuristic Journey Through the Solar System
- 10:30 – 11:00 am Break
- 11:00 am – 12:15 pm **CONCURRENT SESSIONS A**
- Room: Xavier**
Programming for audiences with special needs
- Room: Dolores**
Effective facilitation techniques and strategies to have conversations with your audiences
- Room: Joshua Tree**
Getting the most out of your Sun, Earth, Universe exhibition
- Room: Campanile**
Getting the most out of your Explore Science: Earth & Space toolkits at your institution
- Room: Cavetto**
Programs and resources to engage teens and adults
- Room: Augustine**
Partnerships with youth-serving organizations
- 12:15 – 1:00 pm Lunch served, Cloister Dining
- 12:30 – 1:30 pm **REGIONAL HUB MEETINGS** (bring lunch from Cloister Dining)

1:30 – 1:45 pm	Break
1:45 – 3:00 pm	CONCURRENT SESSIONS B Room: Xavier Working with teachers and schools to engage K–12 students in informal learning environments Room: Dolores Incorporating Earth and space science content into your summer camp Room: Joshua Tree Planning successful BIG events such as anniversaries, celebrations, and festivals Room: Campanile How to prepare and train event volunteers and staff Room: Cavetto Collaborating with experts: How to find and collaborate with Subject Matter Experts Room: Augustine Partnerships with community organizations and libraries
3:00 – 3:15 pm	Break
3:15 – 5:15 pm	NASA SCIENCE ACTIVATION SHOWCASE , Palm Ballroom CF NASA 10-MIN TECHNOLOGY TALKS , Palm Ballroom ABDE
5:15 – 5:55 pm	Break until dinner
5:55 pm	Group photo, Courtyard
6:00 – 6:30 pm	Dinner served, Palm Ballroom
6:30 – 7:45 pm	DINNER PLENARY Ed Finn, <i>The Center for Science and the Imagination</i> , ASU Science and Imagination: A Blueprint for Better Futures
7:45 – 9:00 pm	Networking reception and mixer, Courtyard Telescope viewing, 2nd Floor, roof area

FRIDAY, FEBRUARY 15

Tempe Mission Palms Hotel, Plenaries in Palm Ballroom ABDE

8:00 – 8:30 am	Breakfast
8:30 – 9:00 am	PLENARY Welcome, Charge for the Day
9:00 – 10:30 am	PLENARY Big Stories in Earth & Space Science Moderator: Darrell Porcello, <i>Children's Creativity Museum</i> Lin Chambers, <i>NASA Langley Research Center</i> Brian Day, <i>NASA Solar System Exploration Research Virtual Institute</i> Emily Law, <i>NASA Jet Propulsion Laboratory</i> Lou Mayo, <i>NASA Goddard Space Flight Center</i> Horace Mitchell, <i>NASA Goddard Space Flight Center</i> Theresa Schwerin, <i>Institute for Global Environmental Strategies</i> Denise Smith, <i>Space Telescope Science Institute</i>

10:30 – 11:00 am Break

11:00 am – 12:15 pm **CONCURRENT SESSION C**

Room: Xavier

Engaging families and young children in Earth and space science content

Room: Dolores

Partnerships in unusual places (places of worship, prisons, the beach, and canoes):
Best practices, strategies, and resources for local partnerships

Room: Joshua Tree

Resources and strategies for engaging girls

Room: Campanile

Resources and strategies for engaging bilingual audiences

Room: Cavetto

A conversation about the needs and future of public engagement in Earth and space science

Room: Augustine

Making Earth and space science relevant to specific audiences and adapting to local needs

12:15 – 1:00 pm Lunch served, Cloister Room

12:30 – 1:30 pm **LUNCH PLENARY** (bring lunch from Cloister Dining)

1:30 pm Meeting Concludes



Featured Speakers



Jim Bell

Jim Bell is professor in the School of Earth and Space Exploration at Arizona State University and president of The Planetary Society, the world's largest public space advocacy organization. His research group at ASU primarily focuses on the geology, geochemistry, and mineralogy of planets, moons, asteroids, and comets using data obtained from telescopes as well as spacecraft missions to these worlds.

Bell is the plenary speaker Thursday morning:

The Ultimate Interplanetary Travel Guide: A Futuristic Journey Through the Solar System

Do you dream of traveling to other worlds? Well, then, why not? Come with noted astronomer, planetary scientist, and interplanetary travel guide Professor Jim Bell on a predictive tour of what the solar system will have to offer in the year 2218. Hiking, sightseeing, photography, musical performances, fine dining, extreme sports, even citizen science research opportunities abound across our solar system, from Mercury through the gas giants and moons of the outer planets, and even beyond. How should you dress? What should you bring? What kinds of adventures can you expect? Let's find out!



Lindy Elkins-Tanton

Lindy Elkins-Tanton is director of the School of Earth and Space Exploration at Arizona State University, co-chair of the Interplanetary Initiative, and principal investigator of Psyche, selected in 2017 as the fourteenth mission in NASA's Discovery program.

Elkins-Tanton is the plenary speaker Wednesday evening:

Space Initiatives at ASU

The drive that humans have to explore is increasingly taking us to space. ASU is one of the university leaders in space exploration: right now we are involved in 17 active missions. Our faculty have contributed instruments to missions at the Moon, Mars, and asteroids, and we are leading missions to the Moon, to search for exoplanets, and to the metal world Psyche. Further, the ASU Interplanetary Initiative is working on defining and creating our human space future combining disciplines including policy, psychology, philosophy, sociology, science, and engineering. In this presentation I'll talk about the progress of the Psyche mission and the latest projects in research and education in the Interplanetary Initiative.



Ed Finn

Ed Finn is founding director of the Center for Science and the Imagination at Arizona State University and associate professor in the School of Arts, Media, and Engineering. He also serves as the academic director of Future Tense, a partnership between ASU, New America, and Slate Magazine, and a co-director of Emerge, an annual festival of art, ideas, and the future. Ed's research and teaching explore digital narratives, creative collaboration, and the intersection of the humanities, arts, and sciences.

Finn is the plenary speaker Thursday evening:

A Blueprint for Better Futures

Most people don't think about the future, or if they do, it is with anxiety or ambivalence. How can we change our relationship with the future and connect positive outcomes with our choices today? This talk will discuss the work of the Center for Science and the Imagination in designing and sharing visions of the future that are imaginative, inclusive, and inspiring.



Larry Bell

Larry Bell is senior vice president for strategic initiatives at the Museum of Science in Boston. He is also a co-investigator of the NISE Network Earth & Space project and a member of the Network's executive group.

Bell is a master of ceremonies for the meeting.



Dave Guston

David H. Guston is professor and founding director of the School for the Future of Innovation in Society at ASU, where he is also co-director of the Consortium for Science, Policy & Outcomes. Professor Guston is widely published and cited on research and development policy, technology assessment, public participation in science and technology, and the politics of science policy.

Guston is extending a welcome from Arizona State University on Wednesday evening.



Paul Martin

Paul Martin is co-director of the Center for Innovation in Informal STEM Learning at Arizona State University. He is principal investigator of the NISE Network Earth & Space project and a member of the Network's executive group.

Martin is a master of ceremonies for the meeting.



Catherine McCarthy

Catherine McCarthy is project leader at the Science Museum of Minnesota. She is a co-investigator of the Earth and space project and a member of the Network leadership team.

With the regional hub leaders, McCarthy is coordinating the concurrent sessions.



Rae Ostman

Rae Ostman is co-director of the Center for Innovation in Informal STEM Learning at Arizona State University. She is director of the NISE Network and a co-investigator of the NISE Network Earth & Space project.

Ostman is presenting during the concluding plenary at Friday's lunch.



Darrell Porcello

Darrell Porcello is director of STEM networks and partnerships at Children's Creativity Museum in San Francisco. He is a co-investigator of the NISE Network's Earth & Space project and a member of the leadership team.

Porcello is moderator for the plenary panel Friday morning.

Concurrent Sessions: A

Thursday, February 14, 11am – 12:15pm

ROOM: XAVIER

PROGRAMS & AUDIENCE ENGAGEMENT

Programming for audiences with special needs

Max Cawley, *Museum of Life and Science, Durham, NC**
Marta Beyer, *Museum of Science, Boston, MA*
Meagan Downey, *Robinson Nature Center, Columbia, MD*
Carolyn Ng, *NASA Goddard Space Flight Center (GSFC), Greenbelt, MD*
Meghan Schiedel, *Terry Lee Wells Nevada Discovery Museum, Reno, NV*

ROOM: DOLORES

PROFESSIONAL DEVELOPMENT

Effective facilitation techniques and strategies to have conversations with your audiences

Christina Leavell, *Science Museum of Minnesota, Saint Paul, MN**
Douglas Coler, *Discovery Place Inc., Charlotte, NC*
Stephanie Long, *Science Museum of Minnesota, Saint Paul, MN*
Sean Rooney, *Oregon Museum of Science and Industry (OMSI), Portland, OR*
Josh Sarver, *Center of Science and Industry (COSI), Columbus, OH*
Anika Taylor, *The Bakken Museum, Minneapolis, MN*

ROOM: JOSHUA TREE

EXHIBITS

Getting the most out of your *Sun, Earth, Universe* exhibition

Ethan Kruszka, *Science Museum of Minnesota, Saint Paul, MN**
Jason Craig, *NASA Jet Propulsion Laboratory (JPL), Pasadena, CA*
Pody Gay, *Discovery Network at Museum of Discovery, Little Rock, AR*
Emily Maletz, *Emily Maletz Graphic Design, Portland, OR*
Tim Rhue, *Space Telescope Science Institute (STScI), Baltimore, MD*

ROOM: CAMPANILE

PROGRAMS

Getting the most out of your Explore Science: Earth & Space toolkits at your institution

Ali Jackson, *Sciencenter, Ithaca, NY**
Jacob Heck, *Bootheel Youth Museum, Malden, MO*
Megan Norris, *miSci Museum of Innovation and Science, Schenectady, NY*
Michael Rathbun, *Discovery Center Museum, Rockford, IL*
Cailee Smith, *ECHO Leahy Center for Lake Champlain, Burlington, VT*
Hever Velazquez, *Science Museum of Minnesota, Saint Paul, MN*

ROOM: CAVETTO

PROGRAMS

Programs and resources to engage teens and adults

Frank Kusiak, *Lawrence Hall of Science, Berkeley, CA**
Derrick Pitts, *The Franklin Institute, Philadelphia, PA*
Hardin Engelhardt, *Marbles Kids Museum, Raleigh, NC*
Brian Levine, *American Museum of Natural History (AMNH), New York, NY*
Michael Roberts, *Morrison Planetarium, Cal Academy, San Francisco, CA*
Lucien Scott, *Creative Discovery Museum, Chattanooga, TN*
Marcos Stafne, *Montshire Museum of Science, Norwich, VT*

ROOM: AUGUSTINE

COLLABORATIONS & PROGRAMS

Partnerships with youth-serving organizations (afterschool programs, scouts, Y's, 4-H, and more)

Brad Herring, *Museum of Life and Science, Durham, NC**
Hadley Andersen, *Bishop Museum, Honolulu, HI*
Rachel Carpenter, *Children's Discovery Museum, Normal, IL*
Jason Hammond, *Children's Museum of Houston, Houston, TX*
Diane LaFollette, *Mid-America Science Museum, Hot Springs, AR*

* Concurrent session organizer

Concurrent Sessions: B

Thursday, February 14, 1:45pm – 3:00pm

ROOM: XAVIER

K–12 COLLABORATIONS & PROFESSIONAL DEVELOPMENT

Working with teachers and schools to engage K–12 students in informal learning environments

Frank Kusiak, *Lawrence Hall of Science, Berkeley, CA**
Lindsay Bartolone, *Children's Creativity Museum, San Francisco, CA*
Chloe Ducette, *Museum of Idaho, Idaho Falls, ID*
Trudi Plummer, *Maine Discovery Museum, Bangor, MA*
Becky Wolfe, *The Children's Museum of Indianapolis, Indianapolis, IN*

ROOM: DOLORES

PROGRAMS

Incorporating Earth and space science content into your summer camp

Ali Jackson, *Sciencenter, Ithaca, NY**
Katie (Kat) Burkhart, *Carnegie Museum of Montgomery County, Crawfordsville, IN*
Sarajane Gomlak-Green, *Buffalo Museum of Science, Buffalo, NY*
Joan Harper-Neely, *National Institute of Aerospace, Hampton, VA*
Christine Shupla, *Lunar and Planetary Institute (LPI), Houston, TX*
Rhea Waldman, *South Dakota Discovery Center, Pierre, SD*

ROOM: JOSHUA TREE

PROGRAMS & AUDIENCE ENGAGEMENT

Planning successful BIG events such as anniversaries, celebrations, and festivals

Christina Leavell, *Science Museum of Minnesota, Saint Paul, MN**
Paul Freiling, *Saint Louis Science Center, Saint Louis, MO*
Deb Novak, *New Mexico Museum of Natural History, Albuquerque, NM*
Keith Ostfeld, *Children's Museum of Houston, Houston, TX*
Aaron Slonecker, *Anchorage Museum, Anchorage, AK*
Nick Whites, *WonderLab Museum of Science, Health and Technology, Bloomington, IN*
Kari Wouk, *North Carolina Museum of Natural Sciences, Raleigh, NC*

ROOM: CAMPANILE

COLLABORATION & PROFESSIONAL DEVELOPMENT

How to prepare and train event volunteers and staff

Catherine McCarthy, *Science Museum of Minnesota, Saint Paul, MN**
Emily Belle, *Sciencenter, Ithaca, NY*
Alex Dour, *Orpheum Children's Museum, Champaign, IL*
Susan Heilman, *Museum of Science, Boston, MA*
Meghan Murray, *Above & Beyond Children's Museum, Sheboygan, WI*
Calvin Uzelmeier, *Rochester Museum & Science Center (RMSC), Rochester, NY*

ROOM: CAVETTO

COLLABORATIONS

Collaborating with experts: How to find and collaborate with Subject Matter Experts

Darrell Porcello, *Children's Creativity Museum, San Francisco, CA**
Patricia Bresee, *Kopernik Observatory & Science Center, Vestal, NY*
Amelia Chapman, *NASA Jet Propulsion Laboratory (JPL), Pasadena, CA*
Kay Ferrari, *NASA Jet Propulsion Laboratory (JPL), Pasadena, CA*
Katherine Kornei, *Children's Creativity Museum, San Francisco, CA*
Brandon Lawton, *Space Telescope Science Institute (STScI), Baltimore, MD*
Rimma Murta, *Maui Science Center, Maui, HI*
Nick Spicher, *Imagine Children's Museum, Everett, WA*
Vivian White, *Astronomical Society of the Pacific (ASP), San Francisco, CA*

ROOM: AUGUSTINE

COLLABORATIONS

Partnerships with community organizations and libraries

Brad Herring, *Museum of Life and Science, Durham, NC**
Stacey Forsyth, *CU Science Discovery, Boulder, CO*
Anne Holland, *Space Science Institute (SSI), Boulder, CO*
Allison Schwanebeck, *Science Center of Iowa, Des Moines, IA*
Ray Vandiver, *Discovery Lab, Tulsa, OK*

* Concurrent session organizer

Concurrent Sessions: C

Friday, February 15, 11am – 12:15pm

ROOM: XAVIER

PROGRAMS

Engaging families and young children in Earth and space science content

Emily Belle, *Sciencenter, Ithaca, NY**
Michelle Kortenaar, *Sciencenter, Ithaca, NY**
Gina Anderson, *The Children's Museum of Green Bay, Green Bay, WI*
Dawn Baldwin, *Children's Museum of Science & Technology (CMOST), Troy, NY*
Margaret Beswick, *Hawaii Children's Discovery Center, Honolulu, HI*
Anne Drake, *Great Lakes Children's Museum, Traverse City, MI*
Anna Hurst, *Astronomical Society of the Pacific (ASP), San Francisco, CA*
Katie Julsrud, *Children's Museum of Eau Claire, Eau Claire, WI*
Stephanie Kadam, *Stepping Stones Museum for Children, Norwalk, CT*

ROOM: DOLORES

COLLABORATIONS

Partnerships in unusual places (places of worship, prisons, the beach, and canoes): Best practices, strategies, and resources for local partnerships

Catherine McCarthy, *Science Museum of Minnesota, Saint Paul, MN**
Alan Brown, *Sci-Port Discovery Center, Shreveport, LA*
Charlie Gibson, *Michigan Science Center, Detroit, MI*
Derrick Pitts, *The Franklin Institute, Philadelphia, PA*
Samantha Sands, *Denver Museum of Nature & Science, Denver, CO*

ROOM: JOSHUA TREE

AUDIENCE ENGAGEMENT

Resources and strategies for engaging girls

Kayla Berry, *Museum of Science, Boston, MA**
Angela Gaige, *Milton J. Rubenstein Museum of Science & Technology (MoST), Syracuse, NY*
Pamela Harman, *SETI Institute, Mountain View, CA*
Erin Hogeboom, *National Girls Collaborative Project, Lynnwood, WA*
Lisa Hoover, *Chabot Space & Science Center, Oakland, CA*
Karyn Knecht, *Eugene Science Center, Eugene, OR*
Linda Shore, *Astronomical Society of the Pacific (ASP), San Francisco, CA*

ROOM: CAMPANILE

AUDIENCE ENGAGEMENT

Resources and strategies for engaging bilingual audiences

John Gordon, *Science Museum of Minnesota, Saint Paul, MN**
Marcie Benne, *Oregon Museum of Science and Industry (OMSI), Portland, OR*
Susan Borland, *Challenger Learning Center, Tallahassee, FL*
Kevin Dille, *Explora, Albuquerque, NM*
Felipe Pena, *Children's Museum of Brownsville, Brownsville, TX*
Dan Steinberg, *Princeton University, Princeton, NJ*

ROOM: CAVETTO

AUDIENCE ENGAGEMENT

A conversation about the needs and future of public engagement in Earth and space science

Rae Ostman, *Arizona State University, Tempe, AZ**
Lin Chambers, *NASA Langley Research Center, Hampton, VA*
Keliann LaConte, *Space Science Institute, Boulder, CO*
Paul Martin, *Arizona State University, Tempe, AZ*
Denise Smith, *Space Telescope Science Institute (STScI), Baltimore, MD*
Theresa Schwerin, *Institute for Global Environmental Strategies (IGES), Arlington, VA*

ROOM: AUGUSTINE

AUDIENCE ENGAGEMENT

Making Earth and space science relevant to specific audiences and adapting to local needs

Darrell Porcello, *Children's Creativity Museum, San Francisco, CA**
Allison Anderson, *Museum of Science, Boston, MA*
Jessica Burke, *Discovery Center of Idaho, Boise, ID*
Mary Dussault, *Harvard-Smithsonian Center for Astrophysics, Cambridge, MA*
Caitlin Ervin, *University of Montana – spectrUM Discovery Area, Missoula, MT*
Zdanna King, *Science Museum of Minnesota, Saint Paul, MN*
Laura Peticolas, *Sonoma State University, Rohnert Park, CA*

Showcase

Palm Ballroom CF

1

OpenSpace/American Museum of Natural History

Carter Emmart

American Museum of Natural History

Rosamond Kinzler

American Museum of Natural History

Dive into craters to explore ancient ice on the Moon! Experience glowing blue sunsets on Mars! Observe the Sun's dynamic activity! Fly to the edge of the observable Universe! Take your audiences on these and other cosmic explorations with OpenSpace, a freely available open-source data visualization tool designed for presenting astronomical, planetary, and space science data from NASA and other sources in a range of settings including exhibitions, immersive theaters, and planetarium domes. Funded as part of NASA's Science Mission Directorate's Science Activation Collective and led by the Science Visualization Group at the American Museum of Natural History in New York City, a growing number of informal science institutions are using OpenSpace to present complex data with clear, compelling, dynamic, and engaging visualizations. Current ISI partners include California Academy of Sciences, Denver Museum of Nature and Science, North Carolina Museum of Natural Sciences, Houston Museum of Nature and Science, The Adler Planetarium, and The Exploratorium.

This software is updated frequently with new data sets and can be used to provide live interactive programs about NASA's exploration of the Solar System, including current missions to Mars and Pluto and historical missions such as Apollo and Voyager. A brief guide will be available with information about downloading and installing the software, basic navigation, tips and tricks, and exciting program ideas that leverage the unique visualization capabilities of OpenSpace.

www.openspaceproject.com

2

Infiniscope/Arizona State University

Ariel Anbar

Arizona State University

Jessica Swan

Arizona State University

Joseph Tamer

Arizona State University

An open-education digital resource for educators of all types, providing a space to connect, create, and collaborate around digital learning experiences and compelling NASA visualizations.

www.infiniscope.org

3

Astronomical Society of the Pacific & NASA's Night Sky Network

Anna Hurst

Astronomical Society of the Pacific

Linda Shore

Astronomical Society of the Pacific

Vivian White

Astronomical Society of the Pacific

The mission of the Astronomical Society of the Pacific (ASP) is to increase the understanding and appreciation of astronomy to advance science literacy. Resources include books, training for formal and informal educators, and hands-on activities for a variety of audiences, from pre-K children to adults.

Administered by the ASP, NASA's Night Sky Network is dedicated to supporting informal astronomy enthusiasts in astronomy clubs across the US. Find out how to partner with these local experts to bring the awe of the night sky to your museum.

nightsky.jpl.nasa.gov
www.astrosociety.org

4

NASA Earth Science Education Collaborative (NESEC)

Tina Harte

NASA Langley Research Center (LaRC)

Holli Kohl

NASA Goddard Space Flight Center (GSFC)

Rusty Low

Institute for Global Environmental Strategies (IGES)

Theresa Schwerin

Institute for Global Environmental Strategies (IGES)

Jessica Taylor

NASA Langley Research Center (LaRC)

NESEC is creating engaging, meaningful, and authentic STEM experiences and resources for educators and learners based on NASA Earth science that are delivered broadly through strategic collaborators and networks like NISE. NESEC is funded by NASA's Science Mission Directorate and is a partnership among four organizations: The Institute for Global Environmental Strategies (IGES) and the Earth Sciences at three NASA Centers: Goddard Space Flight Center, Langley Research Center, and Jet Propulsion Laboratory.

www.globe.gov/web/nasa-earth-science-education-collaborative
observer.globe.gov

5

NASA Solar System Treks/ NASA JPL & NASA Ames

Brian Day

NASA Solar System Exploration Research Virtual Institute

Emily Law

NASA Jet Propulsion Laboratory

NASA's Solar System Treks Project (SSTP) produces web-based interactive visualization and analysis tools that enable mission planners, planetary scientists, students, and the public to explore the surfaces of a growing number of planetary bodies as seen through the eyes of many different instruments aboard a variety of spacecraft. Views can be stacked and blended. Users can interactively fly over peaks and down into valleys in 3D mode; measure distances, heights, and depths of landforms; mark areas for output to 3D printers; and create paths for immersive viewing experience using VR goggles. While originally initiated for mission planning and science, this technology has demonstrated great benefits for STEM engagement and inspiration. As a component of NASA's STEM Activation Infrastructure, they are available as resources for NASA STEM Activation partners, and to the greater outreach and education community. As new missions are being planned to a variety of planetary bodies (including the first human missions to Mars), these tools are facilitating the public's understanding of the missions and engaging the public in the process of identifying and selecting where these missions will land.

trek.nasa.gov

trek.nasa.gov/moon

trek.nasa.gov/mars

trek.nasa.gov/vesta

trek.nasa.gov/ceres

6

NASA Space Science Education Consortium

Carolyn Ng

NASA Goddard Space Flight Center

Lou Mayo

NASA Goddard Space Flight Center

The NASA Space Science Education Consortium (NSSEC) provides an exciting menu of products, programs, and tools to space science education. We will share some of them, including large-scale events (e.g., Eclipse 2017), data-intensive tools (Helioviewer), informal programs (Solarium, planetarium shows), citizen science (Aurorasaurus, Radio JOVE), out-of-school time (Afterschool Universe, Family Science Night) and cross-cutting education technology.

Within NSSEC is a STEM Innovation Lab, which is a think tank for NASA scientists, engineers, and educators to explore and develop new ideas that will infuse educational technology into STEM (Science, Technology, Engineering, and Mathematics) activities, programs, and approaches. It also provides museums a platform to share their ideas, research, and results.

Inside the lab is a variety of interchangeable exploration stations fitted with technologies typically found in many of today's 21st-century educational environments. By placing these stations in close proximity to each other, we encourage users to investigate how the technologies can be effectively blended together for greater impact and integration into NASA education programs and products. In this gathering we will showcase VR, 2D/3D printing, Eclipse Soundscape, and volumetric data display.

NSSEC partners with internal NASA teams as well as external organizations, including professional societies, community groups, universities, informal education venues, and minority-serving institutions. We desire to collaborate with museums and science centers to reach many more diverse populations, including people with physical disabilities.

www.steminnovationlab.org

blogs.nasa.gov/stem-innovation-lab

eclipse2017.nasa.gov

science.nasa.gov/science-activation-team/ nasa-space-science-education-consortium

7

NASA's Museum Alliance

Amelia Chapman

NASA Jet Propulsion Laboratory

NASA's Museum Alliance is a free, active community of practice that provides informal educators access to NASA and its resources via:

- A member website of searchable resources, including a calendar of mission events, deadlines, and anniversaries
- Live and archived professional development teleconferences with NASA experts
- Personal assistance navigating NASA's extensive resources and events

The Alliance provides a platform for sharing your events and exhibits with NASA and its audiences, and advocates for informal education within NASA by providing a central nexus for feedback, requests, and communication between NASA content developers and informal educators.

Over two thousand professionals at more than a thousand museums, science centers, planetariums, Challenger Centers, observatories, parks, libraries, and youth-serving organizations are partners in the Museum Alliance.

informal.jpl.nasa.gov/museum

8

Solar System Ambassadors

Kay Ferrari

NASA Jet Propulsion Laboratory

The Solar System Ambassadors (SSA) program is a nationwide volunteer public engagement effort sponsored by NASA's

Science Mission Directorate and managed by NASA's Jet Propulsion Laboratory. SSAs are space enthusiasts from all walks of life who are asked to conduct and report four events annually where they share NASA's story in ways meaningful to their communities.

Ambassadors are chosen based on their exceptional communication skills and community connections. SSA training involves connecting Ambassadors with NASA scientists and engineers via webinars and telecons, providing them with the most up-to-date information and materials possible to share at their events. Ambassadors are encouraged to collaborate with members of other NASA-supported projects, including the Museum Alliance, Night Sky Network, NASA@ My Library, and the NISE Network.

Currently, there are 1,000 SSA volunteers in all 50 states, US territories, and US military bases and consulates overseas. Over the past 22 years, Solar System Ambassadors have reached almost 9.7 million people directly and more than 484 million people indirectly.

solarsystem1.jpl.nasa.gov/ssa

9

NASA's Eyes/NASA JPL

Jason Craig

NASA/Jet Propulsion Laboratory

NASA's Eyes is a publicly available visualization system created by NASA JPL. Eyes allows users to virtually ride along with NASA missions, view and zoom in to realistic simulations of planets, moons, stars, and space objects studied by NASA scientists. The system is a downloadable program with daily self-updating content from NASA featuring three museum-friendly versions: Eyes on Earth, Eyes on the Solar System, and Eyes on Exoplanets. In addition, the Eyes team is now creating web browser-based simulations that work on your mobile phone.

eyes.nasa.gov

10

NASA eClips™/National Institute of Aerospace

Joan Harper-Neely

National Institute of Aerospace

NASA eClips resources support standards-based instruction by increasing STEM literacy in formal and nonformal settings. The free video segments inform and engage students, through NASA-inspired, real-world connections.

NASA Spotlights are short (90–120 second), student-produced videos designed to debunk nationally recognized science misconceptions. From research to script, to screen, students build their own understanding of the science concept through creative video representations. The NASA Spotlight Design Challenge offers campers opportunities to collaborate creatively to produce science videos for other students.

NASA eClips Guide Lites focus on activities pulled from Educator Guides and are well suited for phenomenon-based science inquiry in nonformal educational settings. All Guide Lites are organized using the 5E learning model.

nasaclips.arc.nasa.gov

11

PLANETS

Lori Ann Rubino-Hare

Northern Arizona University

Planetary Learning that Advances the Nexus of Engineering, Technology, and Science (PLANETS) is an interdisciplinary and cross-institutional partnership to develop and disseminate out-of-school-time (OST) curricular and professional development (PD) modules that integrate planetary science, technology, and engineering. Partners include the Center for Science Teaching and Learning at Northern Arizona University, the U.S. Geological Survey Astrogeology Science Center, and the Museum of Science, Boston.

www.eie.org/engineering-everywhere/curriculum-units

12

SETI Institute

Reaching for the Stars: NASA Science for Girl Scouts

NASA Airborne Astronomy Ambassadors

Pamela Harman

SETI Institute

The SETI Institute (SI) is a 501 (c)(3) nonprofit scientific research institute headquartered in Mountain View, California. SI is a key research contractor to NASA and the National Science Foundation (NSF). The Institute conducts extensive education and outreach. The education programs listed below are funded by NASA SMD Sci Act cooperative agreements.

Reaching for the Stars: NASA Science for Girl Scouts (Girl Scout Stars) engages Girl Scouts and volunteers in NASA astrophysics and planetary science through new Space Science Badges, trainings, Girl Scout Astronomy Clubs, and summer camps. Girl Scout Stars disseminates STEM education-related resources, and fosters interaction between Girl Scouts and Subject Matter Experts (SMEs). The Space Science Explorer, Adventurer, and Investigator Badge Booklets for Daisies, Brownies, and Juniors, respectively, will be available for review with a few activity demos with online resources and Girl Scout Council information.

The NASA Airborne Astronomy Ambassadors (AAA) program is designed to measurably enhance student STEM achievement and engagement in selected school districts via professional development for high school science teachers. AAA participant professional development consists of training in astrophysics and planetary science content in webinar and face-to-face workshop formats, a curriculum unite, as well as a weeklong STEM immersion experience at NASA's science research aircraft facility in Palmdale, California. The SETI Institute will be

recruiting school district partners for the next cycle this spring. Teachers from partner school districts with a signed MOU will submit applications this fall. Program description and timeline will be available for review.

www.seti.org/GirlScoutStars
www.seti.org/aaa

13

NASA@ My Library

Jaime Harold

Space Science Institute

Anne Holland

Space Science Institute

Keliann LaConte

Space Science Institute

NASA@ My Library works with public and state libraries across the country to bring NASA science and exploration to patrons at these venues and their partner sites. NASA@ My Library includes a kit program, professional development and training opportunities, support for Community Dialogues, and a robust evaluation program. The project team will be showcasing items from their successful kit program and free Android apps. Learn about conducting Community Dialogues to work with your community on your programs. Get ideas for partnering with libraries in your community, especially during the 2019 summer celebration of space science and the 50th anniversary of the Apollo moon landing occurring at libraries across the nation.

www.starnetlibraries.org
www.starnetlibraries.org/summer-of-space

14

NASA's Universe of Learning

Mary Dussault

Center for Astrophysics | Harvard & Smithsonian Center

Brandon Lawton

Space Telescope Science Institute (STScI)

Tim Rhue II

Space Telescope Science Institute (STScI)

Denise Smith

Space Telescope Science Institute (STScI)

NASA's Universe of Learning creates and provides resources and experiences that enable youth, families, and lifelong learners to explore fundamental questions in science, experience how science is done, and discover the universe for themselves. Made of organizations embedded within NASA missions and that produce some of the most iconic science and imagery in the world, NASA's Universe of Learning uses its direct connection to the wonders of the cosmos and the experts behind the science to enable learning for people of all ages. NASA's Universe of Learning products and programs provide opportunities to explore current NASA Astrophysics themes in multiple ways, including authentic experiences using data and multimedia.

Come experience a 360 degree fly-through of the Orion Nebula, explore the colors of visible and invisible light through ViewSpace, and search the heavens with robotic telescopes that you direct with our MicroObservatory. These and other interactive and immersive experiences allow for learners to make a personal connection to our universe.

www.universe-of-learning.org
www.viewspace.org
mo-www.cfa.harvard.edu/MicroObservatory

15

LPI: Resources for Museums and Informal Education Venues

Christine Shupla

*Universities Space Research Association (USRA)
Lunar and Planetary Institute (LPI)*

The Lunar and Planetary Institute has a variety of Earth and Space Science resources for museums and other out-of-school-time venues, including small traveling exhibits, Explore hands-on activities, the Lunar and PlanetARy App, the latest planetary science news, and more.

www.lpi.usra.edu/education/out-of-school

16

Northwest Earth and Space Sciences Pipeline

Tedrick Mealy

NESSP

Northwest Earth and Space Sciences Pipeline (NESSP) is a collaborative NASA-funded STEM education program serving students, teachers, and their diverse communities throughout the Pacific Northwest. Our focus is to reach communities that are under-served and under-represented in STEM. This year we are holding a celebration of the 50th Anniversary of the Apollo 11 Moon landing through a drone and robot challenge called the Apollo Next Giant Leap Student Challenge (ANGLeS Challenge). Thirteen hubs around the nation have agreed to hold Regional Hub Challenges using NESSP's model, and teams that win at these challenges will earn the grand prize of a trip to Johnson Space Center in Houston, Texas! Full information, registration, and the Challenge manual will all be available at www.nwessp.org/apollo50 on February 1, 2019.

www.nwessp.org

17

Gulf of Maine Research Institute

Jeff Bate

Gulf of Maine Research Institute

The Gulf of Maine Research Institute pioneers collaborative solutions to global ocean challenges. Located in Portland, Maine, GMRI is dedicated to the resilience of the Gulf of Maine ecosystem and the communities that depend on it. In service of this mission, we provide free, immersive, and authentic science education experiences for learners of all ages across Maine and beyond.

Through a five-year, NASA-funded project, we and our collaborating partners are developing interactive ways in which learners can explore the local impacts of climate change through the lens of both global and local data. An essential aspiration of the project is to understand and create a model for how data-centric experiences developed in and for one place can be made applicable anywhere. Our goal is for learners in many locations to engage with a rich array of science and mathematics as they consider the connections between local science and global-scale processes, the evidence of a changing climate, and the ways human activity and climate intersect with natural systems.

What local climate story do you wish you could tell? What data sets do you need to tell it? We want to talk with and learn from science centers interested in developing highly localized, data-rich engagements around climate change to better understand the challenges and opportunities involved.

www.gmri.org

18

Scientific Visualization Studio/NASA Goddard Space Flight Center

Horace Mitchell

NASA Goddard Space Flight Center

The NASA Scientific Visualization Studio (SVS) works with NASA-affiliated programs and researchers to visualize their data for the purpose of communicating their goals and results in an exciting and accurate manner. All of the visual products created by the SVS and its partner groups are made available

through its website and are completely free for use by the public. Although not strictly created for STEM education, SVS visualizations dramatically illustrate scientific concepts and discoveries in a way that bridges the gap between scientific knowledge and the real-world application of that knowledge. The SVS is also open to modifying existing visualizations so as to better fit the needs of external users.

svs.gsfc.nasa.gov

Parallel Technology Talks

During the Showcase: Palm Ballroom ABDE

These short talks will focus on setup and use of four popular technology platforms relevant to museum educators and visitors.

Open Space (3:15 and 4:15 pm)

Refer to Showcase 1 above.

openspaceproject.com

Globe Observer App (3:30 and 4:30 pm)

Refer to Showcase 4 above.

observer.globe.gov

ViewSpace (3:45 and 4:45 pm)

Refer to Showcase 14 above

viewspace.org

Solar System Treks (4:00 and 5:00 pm)

Refer to Showcase 5 above

trek.nasa.gov



Regional Hub Map

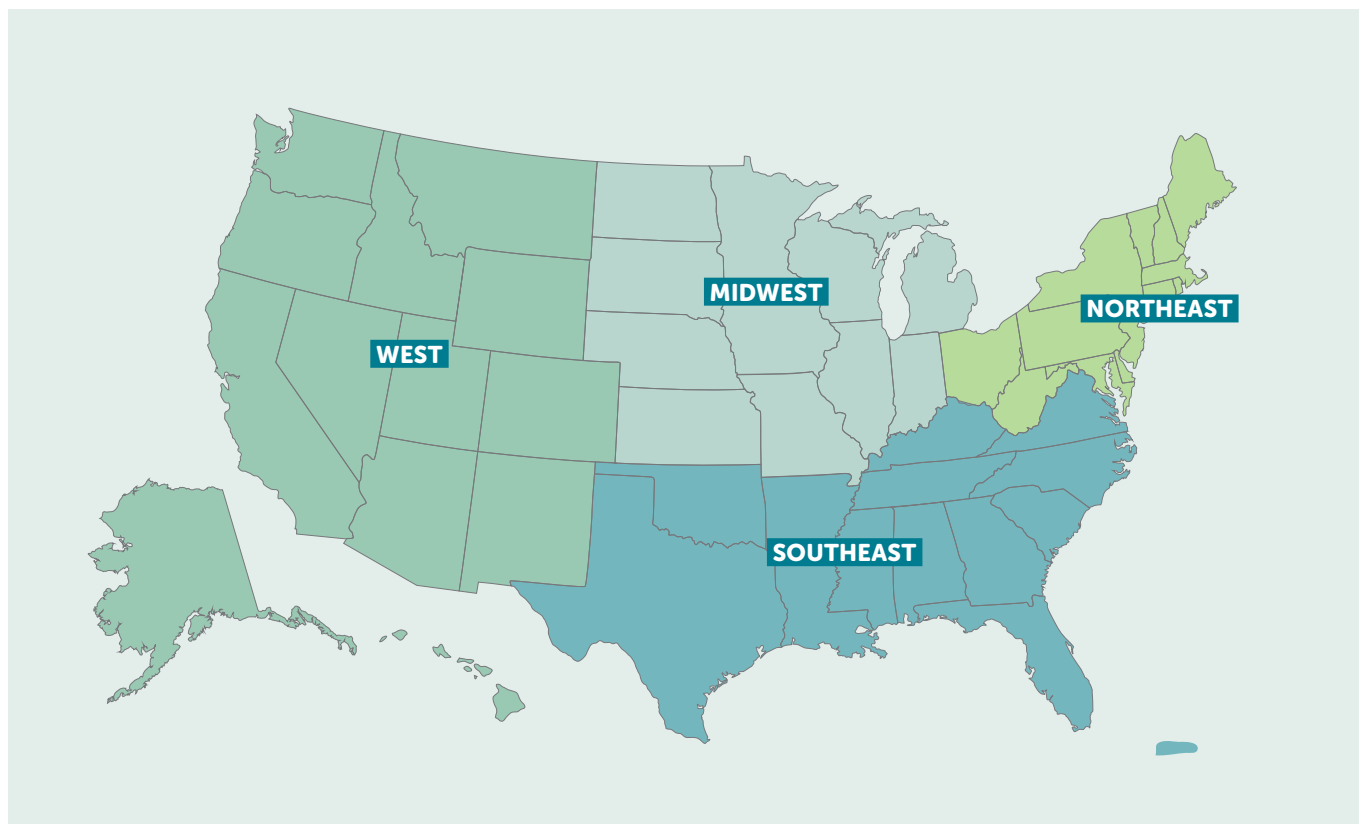

NISE NETWORK REGIONAL HUB LEADERS

The NISE Network community within the United States is organized around four "Regional Hubs" based on geographic proximity. Regional hubs facilitate partner interaction in the Network, help museum educators connect with scientists and each other, and provide support to institutions in their region. To get more involved with the Network, find your region on the map, and contact your Regional Hub Leader.



NORTHEAST

CT, DC, DE, MA, MD, ME, NH, NY, NJ, OH, PA, RI, VT, WV

Ali Jackson

Sciencenter, Ithaca, NY

ajackson@sciencenter.org

607-272-0600 x144



SOUTHEAST

AL, AR, FL, GA, KY, LA, MS, NC, OK, SC, TN, TX, VA,
Puerto Rico & US Virgin Islands

Brad Herring

Museum of Life and Science, Durham, NC

brad.herring@lifeandscience.org

919-220-5429 x360



MIDWEST

IA, IL, IN, KS, MI, MN, MO, ND, NE, SD, WI

Christina Leavell

Science Museum of Minnesota, St. Paul, MN

cleavell@smm.org

651-221-9434



WEST

AK, AZ, CA, CO, HI, ID, MT, NM, NV, OR, UT, WA, WY,
American Samoa & Guam

Frank Kusiak

UC Berkeley Lawrence Hall of Science, Berkeley, CA

frank_kusiak@berkeley.edu

510-643-7827

Participant List

By Last Name

Anbar, Ariel

ASU School of Earth and Space Exploration
Tempe, AZ
anbar@asu.edu

Andersen, Hadley

Bishop Museum
Honolulu, HI
hadley.andersen@gmail.com

Anderson, Allison

Museum of Science, Boston
Boston, MA
aanderson@mos.org

Anderson, Gina

The Children's Museum of Green Bay
Green Bay, WI
ganderson@gbchildrensmuseum.org

Arnold, Sarah

Fernbank Museum of Natural History
Atlanta, GA
sarah.arnold@fernbankmuseum.org

Arseneau, Jennifer

University of Alaska Museum of the North
Fairbanks, AK
j.arseneau@alaska.edu

Ash, Deron

ASU School for the Future of Innov. in Society
Tempe, AZ
deron.ash@asu.edu

Bailey, Melinda

Humboldt State University Natural History Museum (HSU)
Arcata, CA
mjb11@humboldt.edu

Baldwin, Dawn

Children's Museum of Science & Technology (CMOST)
Troy, NY
dbaldwin@cmost.org

Baliga, Alana

Science Spectrum
Lubbock, TX
alana@sciencespectrum.org

Barracough, Amy

Edelman Planetarium at Rowan University
Glassboro, NJ
barracough@rowan.edu

Bartlett, Lindsay

Lincoln Children's Museum
Lincoln, NE
lbartlett@lincolncchildrensmuseum.org

Bartolone, Lindsay

Children's Creativity Museum
San Francisco, CA
lindsaybartolone@gmail.com

Bate, Jeff

Gulf of Maine Research Institute
Portland, ME
jbate@gmri.org

Beaudry, Louise

South Shore Natural Science Center
Norwell, MA
lbeaudry@ssymca.org

Beery, Nicolas

Beery Media, LLC
Hillsborough, NC
nic@beerymedia.com

Bell, Jim

ASU School of Earth and Space Exploration
Tempe, AZ
Jim.Bell@asu.edu

Bell, Larry

Museum of Science, Boston
Boston, MA
lbell@mos.org

Bell, Shawn

Univ of Ark., Center for Math and Science Ed.
Fayetteville, AR
seb010@uark.edu

Belle, Emily

Sciencenter
Ithaca, NY
ebelle@sciencenter.org

Benne, Marcie

Oregon Museum of Science and Industry (OMSI)
Portland, OR
mbenne@omsi.edu

Bennett, Ira

ASU School for the Future of Innov. in Society
Tempe, AZ
ira.bennett@asu.edu

Bermudez, Aida

Eastern Kentucky University - Hummel Planetarium
Richmond, KY
aida.bermudez@eku.edu

Berry, Kayla

Museum of Science, Boston
Boston, MA
kberry@mos.org

Beswick, Margaret

Hawaii Children's Discovery Center
Honolulu, HI
margo@discoverycenterhawaii.org

Beyer, Marta

Museum of Science, Boston
Boston, MA
mbeyer@mos.org

Bickhart, Erica

Children's Museum of Findlay
Findlay, OH
erica@cmfindlay.com

Blansett, Tonya

Tulsa Air & Space Museum & Planetarium
Tulsa, OK
tblansett@tulsamuseum.org

Borland, Susan

Challenger Learning Center - Tallahassee
Tallahassee, FL
sborland@challengertlh.fsu.edu

Botelho, Kim

Nantucket Maria Mitchell Association
Nantucket, MA
kbotelho@mariamitchell.org

Bresee, Patricia

Kopernik Observatory & Science Center
Vestal, NY
sbresee@aol.com

Briere, Dean

Sciencenter
Ithaca, NY
dbriere@sciencenter.org

Brown, Alan

Sci-Port Discovery Center
Shreveport, LA
abrown@sciport.org

Buchanan, Brian

Danville Science Center
Danville, VA
bbuchanan@smv.org

Bullock, Katherine

Living Arts and Science Center
Lexington, KY
kbullock@lasclx.org

Burke, Jessica

Discovery Center of Idaho
Boise, ID
j.burke@dcidaho.org

Burkhart, Katie (Kat)

Carnegie Museum of Montgomery County
Crawfordsville, IN
carnegie@cdpl.lib.in.us

Carpenter, Rachel

Children's Discovery Museum
Normal, IL
rcarpenter@normal.org

Cavazos, Sandra

Imaginarium of South Texas
Laredo, TX
scavazos@imaginariustx.org

Cawley, Max

Museum of Life and Science
Durham, NC
Max.Cawley@LifeandScience.org

Chalasani, Laahiri

Children's Science Center
Fairfax, VA
laahirichalasani@childsci.org

Chambers, Lin

NASA Langley Research Center
Hampton, VA
lin.h.chambers@nasa.gov

Chapman, Amelia

NASA Jet Propulsion Laboratory (JPL)
Pasadena, CA
amelia.j.chapman@jpl.nasa.gov

Christian, Laura

Discovery Children's Museum
Las Vegas, NV
LChristian@discoverykidslv.org

Clouse, Ashley

Thanksgiving Point Institute
Lehi, UT
aclouse@thanksgivingpoint.org

Coler, Douglas

Discovery Place, Inc.
Charlotte, NC
DouglasC@discoveryplace.org

Colton, Jeannie

ASU School for the Future of Innov. in Society
Tempe, AZ
jeannie.colton@asu.edu

Conod, Kevin

Newark Museum
Newark, NJ
kconod@newarkmuseum.org

Cooper, Lawrence

McWane Science Center
Birmingham, AL
lcooper@mcwane.org

Couillard, Carol

Paper Discovery Center
Appleton, WI
Carol@paperdiscoverycenter.org

Craig, Jason

NASA Jet Propulsion Laboratory (JPL)
Pasadena, CA
jason.s.craig@jpl.nasa.gov

Criss, Lacey

Adventure Science Center
Nashville, TN
lcriss@adventuresci.org

Cummings-Rocke, Maizie

Rockville Science Center
Rockville, MD
mc-rocke@juno.com

Cunningham, Chris

KidsQuest Children's Museum
Bellevue, WA
chris@kidsquestmuseum.org

Curry, Meghan

Insights El Paso Science Center
El Paso, TX
meg@insightselpaso.org

Custer, Sari

Arizona Science Center
Phoenix, AZ
custers@azscience.org

Dariento, Michele

Brookhaven National Laboratory's Science Learning Center
Upton, NY
mdariento@bnl.gov

Das, Jayatri

Franklin Institute
Philadelphia, PA
jdas@fi.edu

Daugherty, Breanne

ExpERIENCE Children's Museum
Erie, PA
education@eriechildrensmuseum.org

Day, Brian H.

NASA Solar System Exploration Research Virtual Institute
Moffett Field, CA
Brian.H.Day@nasa.gov

DeVoss, Shelly

The Science Zone
Casper, WY
Shelly.Devoss@thesciencezone.org

Diamond, Teri

Challenger Learning Center of Alaska
Kenai, AK
teri.diamond@akchallenger.org

Dilley, Kevin

Explora Science Museum
Albuquerque, NM
kdilley@explora.us

Dione, Donna

Children's Museum of SE CT
Niantic, CT
d.dione@cmsect.org

Dixon, Jon

Kentucky Science Center
Louisville, KY
dixonjp@miamioh.edu

Dooling, Dave

New Mexico Museum of Space History
Alamogordo, NM
dave.dooling@state.nm.us

Doucette, Chloe

Museum of Idaho
Idaho Falls, ID
education@museumofidaho.org

Dour, Alex

Orpheum Children's Museum
Champaign, IL
education@orpheumkids.com

Downey, Meagan

Robinson Nature Center
Columbia, MD
mdowney@howardcountymd.gov

Downing, Katy

Lake Erie Nature & Science Center
Bay Village, OH
KatyD@lensc.org

Drake, Anne

Great Lakes Children's Museum
Traverse City, MI
adrake@glcm.org

Dreiling, Dillon

Museum of Science and Industry (MSI)
Chicago, IL
dillon.dreiling@msichicago.org

Dresher, Pamela

Bradbury Science Museum
Los Alamos, NM
padresher@lanl.gov

Dussault, Mary

Harvard-Smithsonian Center for Astrophysics
Cambridge, MA
mdussault@cfa.harvard.edu

Eakes, Nick

Morehead Planetarium and Science Center
Chapel Hill, NC
neakes@live.unc.edu

Eilers, Alex
Pink Palace Museum
Memphis, TN
Alex.Eilers@memphistn.gov

Elkins-Tanton, Lindy
ASU School of Earth and Space Exploration
Tempe, AZ
lelinst@asu.edu

Emmart, Carter
American Museum of Natural History
New York, NY
carter@amnh.org

Engelhardt, Hardin
Marbles Kids Museum
Raleigh, NC
hengelhardt@marbleskidsmuseum.org

Epstein, Bonnie
Rhode Island Museum of Science and Art (RIMOSA)
Providence, RI
bepstein@rimosa.org

Ervin, Caitlin
spectrUM Discovery Area
Missoula, MT
caitlin.ervin@umontana.edu

Farr, Jessica
Fairbanks Children's Museum
Fairbanks, AK
jessica@fairbankschildrensmuseum.com

Feilzer, Sara
Exploration Works!
Helena, MT
saraf@explorationworks.org

Ferrari, Kay
NASA Jet Propulsion Laboratory (JPL)
Pasadena, CA
kay.a.ferrari@jpl.nasa.gov

Finn, Edward
Center for Science and the Imagination
Tempe, AZ
edfinn@asu.edu

Flynn, Claire
Long Island Children's Museum (LICM)
Garden City, NY
cflynn@licm.org

Forsyth, Stacey
CU Science Discovery, Univ Colorado Boulder
Boulder, CO
stacey.forsyth@colorado.edu

Freiling, Paul
Saint Louis Science Center
Saint Louis, MO
paul.freiling@slsc.org

Freund, Brian
Maryland Science Center
Baltimore, MD
bfreund@mdsci.org

Gaige, Angela
Milton J. Rubenstein Museum of Science & Technology (MoST)
Syracuse, NY
agaige@most.org

Gamba, Renee
Krupowicz Planetarium
Providence, RI
rgamba@mpsri.net

Garcia, Rachel
SPI Spot
Mount Vernon, OH
RachelSPISpot@gmail.com

Garza, Mary Jane
Corpus Christi Museum of Science and History
Corpus Christi, TX
DrMJ@ccmuseum.com

Gay, Pody
Discovery Network at Museum of Discovery
Little Rock, AR
pgay@museumofdiscovery.org

Gergeni, Chris
Bayou County Children's Museum
Thibodaux, LA
cgergeni@bccm.info

Gibson, Charles
Michigan Science Center
Detroit, MI
Charles.Gibson@mi-sci.org

Gilmartin, Victoria
Exploration Place
Wichita, KS
victoria.gilmartin@exploration.org

Godin, Kathy
Kalamazoo Valley Museum
Kalamazoo, MI
kgodin@kvcc.edu

Gomlak-Green, Sarajane
Buffalo Museum of Science
Buffalo, NY
sgreen@sciencebuff.org

Gordon, John
Science Museum of Minnesota
Saint Paul, MN
jgordon@smm.org

Greene, Melanie
Bisbee Science Exploration & Research Center
Bisbee, AZ
melanie@mgreenepd.com

Grimm-Vavlitis, Jarrett
Kidzu Children's Museum
Chapel Hill, NC
grimm@kidzuchildrensmuseum.org

Groft, Tyler
Da Vinci Science Center
Allentown, PA
tyler@davincisciencecenter.org

Guston, David
ASU School for the Future of Innov. in Society
Tempe, AZ
david.guston@asu.edu

Hale, Lucy
EcoTarium
Worcester, MA
lhale@ecotarium.org

Hammond, Jason
Children's Museum of Houston
Houston, TX
jhammond@cmhouston.org

Hancock, Wendy
Association of Science-Technology Centers (ASTC)
Washington, DC
whancock@astc.org

Harman, Pamela
SETI Institute
Mountain View, CA
pharman@seti.org

Harold, James
Space Science Institute (SSI)
Boulder, CO
harold@SpaceScience.org

Harper-Neely, Joan
National Institute of Aerospace
Hampton, VA
joan.harper-neely@nianet.org

Harrelson, Johlynn
Greensboro Children's Museum
Greensboro, NC
jharrelson@gcmuseum.com

Harte, Tina
NASA Langley Research Center
Hampton, VA
tina.r.harte@nasa.gov

Heck, Jacob
Bootheel Youth Museum
Malden, MO
jacobheck01@bootheelyouthmuseum.org

Heilman, Susan
Museum of Science, Boston
Boston, MA
sheilman@mos.org

Heister, Etta
Ann Arbor Hands On Museum (AAHOM)
Ann Arbor, MI
etta@lesliesnc.org

Hendrickson, Heather
Children's Museum in Oak Lawn
Oak Lawn, IL
heather@cmoaklawn.org

Hennessy, Mike
Carnegie Science Center
Pittsburgh, PA
HennessyM@CarnegieScienceCenter.org

Herring, Brad
Museum of Life and Science
Durham, NC
mbradfordherring@gmail.com

Hill, Ashley
Thinkery
Austin, TX
ahill@thinkeryaustin.org

Hill, Matt
Impression 5 Science Center
Lansing, MI
hill@impression5.org

Hogeboom, Erin
National Girls Collaborative Project
Lynwood, WA
ehogeboom@ngcproject.org

Holland, Anne
Space Science Institute (SSI)
Boulder, CO
aholland@spacescience.org

Holmberg, Carole
Museum of York County
Rock Hill, SC
Cholmberg@chmuseums.org

Hoover, Lisa
Chabot Space & Science Center
Oakland, CA
lhoover@chabotspace.org

Hunt, Katherine
Ingram Planetarium, Museum of Coastal Carolina
Houston, TX
katherine@museumplanetarium.org

Hurst, Anna
Astronomical Society of the Pacific (ASP)
San Francisco, CA
ahurst@astrosociety.org

Isaacson, Jenna
Washington Pavilion, Kirby Science Discovery Center
Sioux Falls, SD
jisaacson@washingtonpavilion.org

Ivanovich, Donitza
Powerhouse Science Center
Durango, CO
donitza@powsci.org

Jackson, Ali
Sciencenter
Ithaca, NY
ajackson@sciencenter.org

Janovec, Terese
Nebraska Center for Materials and Nanoscience
Lincoln, NE
tjanovec3@unl.edu

Jones, Virginia
Idaho Museum of Natural History
Pocatello, ID
jonevir2@isu.edu

Juarez, Juanita
California Science Center
Los Angeles, CA
jjjuarez@cscmail.org

Julsrud, Katie
Children's Museum of Eau Claire
Eau Claire, WI
katie@childrensmuseumec.com

Kadam, Stephanie
Stepping Stones Museum for Children
Norwalk, CT
stephanie@steppingstonesmuseum.org

Kaltenbach, Robyn
Great Lakes Science Center
Cleveland, OH
kaltenbachr@glsc.org

Kannenberg, Jared
Family Museum of Arts and Science
Bettendorf, IA
jkannenbergt@bettendorf.org

Karlen, Kia
Madison Children's Museum
Madison, WI
kkarlen@madisonchildrensmuseum.org

Kary, Jill
Arkansas State University Museum
Jonesboro, AR
jkary@astate.edu

Kay, Tracy
Westchester Children's Museum
Rye, NY
tkay@discoverWCM.org

Keller, Margaret
Akron Children's Museum
Akron, OH
education@akronkids.org

Ken, Brandt
Robeson Planetarium and Science Center
Lumberton, NC
brandt@uncp.edu

Kiker, Kerri
Cradle of Aviation Museum
Garden City, NY
kkiker@cradleofaviation.org

King, Zdanna
Science Museum of Minnesota
Saint Paul, MN
zking@smm.org

Kinzler, Rosamond
American Museum of Natural History
New York, NY
rkinzler@amnh.org

Kirk, Sina
ASU School of Earth and Space Exploration
Tempe, AZ
Sina.Kirk@asu.edu

Kmietowicz, Michael
Orlando Science Center
Orlando, FL
mkmietowicz@osc.org

Knecht, Karyn
Eugene Science Center
Eugene, OR
kknecht@sciencefactory.org

Kohl, Holli
NASA Goddard Space Flight Center (SSAI)
Albuquerque, NM
holli.kohl@nasa.gov

Kornei, Kathy
Children's Creativity Museum
San Francisco, CA
hobbies4kk@gmail.com

Kortenaar, Michelle
Sciencenter
Ithaca, NY
mkortenaar@sciencenter.org

Kremer, Brian
Liberty Science Center
Jersey City, NJ
bkremer@lsc.org

Kruszka, Ethan
Science Museum of Minnesota
Saint Paul, MN
ekruszka@smm.org

Kugler, Brittany
Museum of Discovery
Little Rock, AR
bkugler@museumofdiscovery.org

Kuras, Karen
Boonshoft Museum of Discovery
Dayton, OH
kkuras@boonshoftmuseum.org

Kusiak, Frank
Lawrence Hall of Science
Berkeley, CA
frank_kusiak@berkeley.edu

LaConte, Keliann
Space Science Institute (SSI)
Boulder, CO
klaconte@spacescience.org

LaFollette, Diane
Mid-America Science Museum
Hot Springs, AR
dianel@midamericamuseum.org

Laurence, Nancy
The Muse Knoxville
Knoxville, TN
nancy@themuseknoxville.org

Law, Emily
NASA Jet Propulsion Laboratory (JPL)
Pasadena, CA
emily.s.law@jpl.nasa.gov

Lawton, Brandon
Space Telescope Science Institute (STScI)
Baltimore, MD
lawton@stsci.edu

Leahey, Elizabeth
The Discovery Museums
Acton, MA
eleahey@discoveryacton.org

Leavell, Christina
Science Museum of Minnesota
Saint Paul, MN
cleavell@smm.org

Leavine, Lauren
Great Explorations, The Children's Museum
St. Petersburg, FL
lleavine@greatex.org

Lee, Amanda
San Diego Children's Discovery Museum
Escondido, CA
amandal@sdcdm.org

Lessen, Shelby
Peoria Riverfront Museum
Peoria, IL
slessen@peoriariverfrontmuseum.org

Levine, Brian
American Museum of Natural History
New York, NY
blevine@amnh.org

Liken, Jessica
Perot Museum of Nature and Science
Dallas, TX
jessica.likan@perotmuseum.org

Long, Steph
Science Museum of Minnesota
Saint Paul, MN
slong@smm.org

LoRaso, Janice
The Works: Ohio Center for History, Art and Technology
Newark, OH
janiceloraso@attheworks.org

Lottes, Karen
Gaithersburg Community Museum
Gaithersburg, MD
klottes@gaithersburgmd.gov

Low, Rusty
Institute for Global Environmental Strategies (IGES)
Arlington, VA
rusty_low@strategies.org

Luttjohann, Caitlin
Kansas Children's Discovery Center
Topeka, KS
cluttjohann@kansasdiscovery.org

Lydick, Glenna
SEE Science Center
Manchester, NH
glenna@see-sciencecenter.org

Maletz, Emily
Emily Maletz Graphic Design
Portland, OR
emily@emilymaletz.com

Mannis, Kal
Rural Activation and Innovation Network
Bisbee, AZ
mrkmannis@gmail.com

Martin, Paul
ASU School for the Future of Innov. in Society
Tempe, AZ
paulmartin@asu.edu

Martin, Tiffany
Spark! Imagination and Science Center
Morgantown, WV
educator@sparkwv.org

Matysek, Christyne
Children's Museum of VA - Portsmouth Museums
Portsmouth, VA
matysek@portsmouthva.gov

Mayo, Lou
NASA Goddard Space Flight Center (GSFC)
Greenbelt, MD
Louis.A.Mayo@nasa.gov

Mays, Susan
Museum of Arts and Sciences
Macon, GA
smays@masmacon.com

McCarthy, Catherine
Science Museum of Minnesota
Saint Paul, MN
cmccarthy@smm.org

McConnell, Michael
Science City at Union Station
Kansas City, MO
mmcconnell@unionstation.org

McLaren, Bruce
Regional Science & Discovery Center
Corning, NY
lab@sdsciencecenter.org

Mealy, Tedrick
Northwest Earth and Space Sciences Pipeline
Seattle, WA
mealyt@uw.edu

Mestre, David
Discovery Museum and Planetarium
Bridgeport, CT
dmestre@discoverymuseum.org

Miller, Mary Kate
Golisano Children's Museum of Naples
Naples, FL
weplay@cmn.org

Miller, Sarah
Mayborn Museum Complex
Waco, TX
sarah_c_miller@baylor.edu

Milliron, Jake
Mobius Spokane
Spokane, WA
jmilliron@mobiusspokane.org

Minard, Reena
Lander Children's Museum
Lander, WY
landerchildrensmuseum@gmail.com

Mitchell, Horace
NASA Goddard Space Flight Center (GSFC)
Greenbelt, MD
horace.g.mitchell@nasa.gov

Montgomery, Sheila
Powerhouse Science Center
Sacramento, CA
smontgomery@powerhousesc.org

Moye, Olivia
Gulf Coast Exploreum Science Center
Mobile, AL
omoye@exploreum.com

Murray, Meghan
Above & Beyond Children's Museum
Sheboygan, WI
meghan@abkids.org

Murta, Rrimma
Maui Science Center
Kihei, HI
rimma@mauisciencecenter.com

Nail, Dustyn
Discovery Lab
Tulsa, OK
dnail@discoverylab.org

Needs, Sarah
NASA Wallops Flight Facility
Wallops Island, VA
sarah.j.needs@nasa.gov

Neitzey, Chris
Afterschool Alliance
Washington, DC
cneitzey@afterschoolalliance.org

Ng, Carolyn
NASA Goddard Space Flight Center (GSFC)
Greenbelt, MD
carolyn.y.ng@nasa.gov

Nicholson, Amanda
Roswell Museum and Art Center
Roswell, NM
a.nicholson@roswell-nm.gov

Nordmann, Leila
Fairbanks Museum and Planetarium
Saint Johnsbury, VT
lnordmann@fairbanksmuseum.org

Norris, Megan
miSci Museum of Innovation and Science
Schenectady, NY
megan.norris@misci.org

Norris, Sandra
Lynn Meadows Discovery Center
Gulfpport, MS
hehzrsn@cablone.net

Novak, Deb
New Mexico Museum of Natural History
Albuquerque, NM
deb.novak@state.nm.us

Ogren, Stephanie
Grand Rapids Public Museum
Grand Rapids, MI
sogren@grpm.org

Orr, Russell
Discovery Park of America
Union City, TN
ROrr@discoveryparkofamerica.com

Ortega, Carmen
The Woodlands Children's Museum
The Woodlands, TX
cortega@woodlandschilrensmuseum.org

Ostfeld, Keith
Children's Museum of Houston
Houston, TX
kto@cmhouston.org

Ostman, Rae
ASU School for the Future of Innov. in Society
Tempe, AZ
rostman@asu.edu

Owens, James
Headwaters Science Center
Bemidji, MN
riverhom@paulbunyan.net

Pac, Karen
Imagine Nation Children's Museum
Bristol, CT
karen.pac@imagination.org

Pait, Christopher
South Florida Science Center and Aquarium
West Palm Beach, FL
cpait@sfsccsciencecenter.org

Pariso, Bill
Betty Brinn Children's Museum
Milwaukee, WI
bpariso@bbcmkids.org

Paul, Marcy
Muncie Children's Museum
Muncie, IN
mpaul@munciemuseum.com

Pebdani, Andia
Fleet Science Center
San Diego, CA
publicprograms@rhffleet.org

Pena, Felipe
Children's Museum of Brownsville
Brownsville, TX
felipe@cmofbrownsville.com

Peralez, Megan
SciTech Hands On Museum
Aurora, IL
megan.scitech@gmail.com

Perdew, Olivia
Discovery Space of Central Pennsylvania
State College, PA
olivia@mydiscoveryospace.org

Perrotto, Cathy
Delaware Museum of Natural History (DMNH)
Wilmington, DE
cperrotto@delmnh.org

Perry, Dustin
Lawrence Hall of Science
Berkeley, CA
dustin.perry@berkeley.edu

Peticolas, Laura
Sonoma State University
Rohnert Park, CA
laurap@universe.sonoma.edu

Phan, Brandon
Science Museum of Minnesota
Saint Paul, MN
bphan@smm.org

Pielli, Sloane
Sci-Tech Discovery Center
Frisco, TX
sloane.pielli@scitechdiscovery.org

Pitts, Derrick
Franklin Institute
Philadelphia, PA
dpitts@fi.edu

Plummer, Trudi
Maine Discovery Museum
Bangor, ME
tplummer@mainediscoverymuseum.org

Porcello, Darrell
Children's Creativity Museum
San Francisco, CA
porcello@berkeley.edu

Powell, Cherie
E3 Children's Museum & Science Center
Farmington, NM
cpowell@fmmn.org

Pratt, Megan
Pensacola MESS Hall
Pensacola, FL
megan.pratt@pensacolamesshall.org

Rabalais, Gillian
Children's Museum of St. Tammany
Manderville, LA
grabalais@cmstkids.org

Rasnack, Rebecca
Cincinnati Museum Center
Cincinnati, OH
RRasnack@cincymuseum.org

Rasure, Chris
Discovery Science Place
Tyler, TX
crasure@uttyler.edu

Rathbun, Michael
Discovery Center Museum
Rockford, IL
michaelr@discoverycentermuseum.org

Regester, Martha
Greensboro Science Center
Greensboro, NC
mregester@greensboroscience.org

Rehkamp, Jennifer
Association of Children's Museums (ACM)
Arlington, VA
jennifer.rehkamp@childrensmuseums.org

Reilly, Douglas
AJ Read Science Discovery Center
at SUNY Oneonta
Oneonta, NY
reillydg@oneonta.edu

Rhue, Tim
Space Telescope Science Institute (STScI)
Baltimore, MD
trhue@stsci.edu

Riddle, Thomas
Roper Mountain Science Center
Greenville, SC
tfiddle@greenville.k12.sc.us

Ried, Mandi
Don Harrington Discovery Center
Amarillo, TX
mandi@dhdc.org

Rinehart, Caroline
The Sandbox Children's Museum
Hilton Head Island, SC
crinehart@thesandbox.org

Roberts, Michael
Morrison Planetarium
San Francisco, CA
mroberts@calacademy.org

Robinson, Ian
The Children's Museum
West Hartford, CT
irobinson@thechildrensmuseumct.org

Rooney, Sean
Oregon Museum of Science and Industry (OMSI)
Portland, OR
srooney@omsi.edu

Rubino-Hare, Lori
Northern Arizona University
Flagstaff, AZ
Lori.Hare@nau.edu

Ruby, Dan
ScienceWorks Hands-On Museum
Ashland, OR
dan@scienceworksmuseum.org

Rushin Irr, Melissa
Children's Museum of Yuma County
Yuma, AZ
melissa@yumachildrensmuseum.com

Sands, Samantha
Denver Museum of Nature & Science
Denver, CO
Samantha.Sands@dmns.org

Santana, Anne
Fort Worth Museum of Science and History
Fort Worth, TX
asantana@fwms.org

Santiago, Sujeily
Arecibo Observatory - Angel Ramos
Foundation Visitor Center
Arecibo, PR
sujeily.santiago@naic.edu

Sarver, Josh
Center of Science and Industry (COSI)
Columbus, OH
jsarver@cosi.org

Sava, Mitch
Museum of Life and Science
Durham, NC
mitchell.sava@lifeandscience.org

Schiedel, Meghan
Terry Lee Wells Nevada Discovery Museum
Reno, NV
mschiedel@nvdnm.org

Schnoor, Diane
Shenandoah Valley Discovery Museum
Winchester, VA
dianejacksonschnoor@gmail.com

Schwanebeck, Allison
Science Center of Iowa
Des Moines, IA
allison.schwanebeck@sciowa.org

Schwerin, Theresa
Institute for Global Environmental
Strategies (IGES)
Arlington, VA
theresa_schwerin@strategies.org

Scott, Lucien
Creative Discovery Museum
Chattanooga, TN
lgs@cdmfun.org

Shore, Linda
Astronomical Society of the Pacific (ASP)
San Francisco, CA
lshore@astrosociety.org

Shupla, Christine
Lunar and Planetary Institute (LPI)
Houston, TX
shupla@lpi.usra.edu

Slonecker, Aaron
Anchorage Museum
Anchorage, AK
aslonecker@anchagemuseum.org

Smas, Scott
ASU School of Earth and Space Exploration
Tempe, AZ
Scott.Smas@asu.edu

Smith, Cailee
ECHO Leahy Center for Lake Champlain
Burlington, VT
csmith@echovermont.org

Smith, Denise
Space Telescope Science Institute (STScI)
Baltimore, MD
dsmith@stsci.edu

Smith, Mike
North Museum of Nature and Science
Lancaster, PA
msmith@northmuseum.org

Smith Syden, Sarah
The Children's Museum at Saratoga
Saratoga Springs, NY
executivedirector@cmsny.org

Spicher, Nick
Imagine Children's Museum
Everett, WA
NickS@imaginecm.org

Spinks, Kellie
Hands On! Children's Museum
Hendersonville, NC
kellie@handsonwnc.org

Stafne, Marcos
Montshire Museum of Science
Norwich, VT
marcos.stafne@montshire.org

Steinberg, Daniel
Princeton University
Princeton, NJ
dsteinbe@princeton.edu

Stoltz, Courtney
Gateway to Science
Bismarck, ND
courtney@gsience.org

Swann, Jessica
ASU School of Earth and
Space Exploration
Tempe, AZ
jlswann@asu.edu

Talley, Jason
St. Charles Parish Library Planetarium
Luling, LA
jason.talley@myscpl.org

Tamer, Joe
ASU School of Earth and Space Exploration
Tempe, AZ
atamer@asu.edu

Taylor, Anika
The Bakken Museum
Minneapolis, MN
taylor@thebakken.org

Taylor, Jessica
NASA Langley Research Center
Hampton, VA
jessica.e.taylor@nasa.gov

Taylor, Suzi
Montana State University
Bozeman, MT
taylor@montana.edu

Telemeco, Melissa
Fresno State, Downing Planetarium
Fresno, CA
mtelemeco@csufresno.edu

Thomas, Kamlynn
Arizona Science Center
Phoenix, AZ
thomask@azscience.org

Thompson, Nora
Port Discovery Children's Museum
Baltimore, MD
nthompson@portdiscovery.org

Thornton, Amy
Cape Fear Museum
Wilmington, NC
athornton@nhcgov.com

Toohill, Kelli
Wise Wonders Children's Museum
Billings, MT
ktoohill@wisewonders.org

Torres, Donna
Infinity Science Center
Pearlinton, MS
dtorres@visitinfinity.com

Turman, Lori
Oklahoma Wondertorium
Stillwater, OK
lori.turman@okwondertorium.org

Turner, Sara
IMAG History and Science Center
Fort Myers, FL
sara@theimag.org

Unger, Beth
Fort Collins Museum of Discovery
Fort Collins, CO
bunger@fcmod.org

Uzelmeier, Calvin
Rochester Museum & Science Center
(RMSC)
Rochester, NY
cuzelmeier@rmsc.org

Valencia, Sandra
Columbia Memorial Space Center
Downey, CA
svalencia@downeyspacecenter.org

Vandiver, Ray
Discovery Lab
Tulsa, OK
rvandiver@discoverylab.org

Velazquez, Hever
Science Museum of Minnesota
Saint Paul, MN
hvelazquez@smm.org

Wadnerkar, Urmila
Museum of Science and Industry (MOSI)
Tampa Bay, FL
urmila.wadnerkar@mosi.org

Waldman, Rhea
South Dakota Discovery Center
Pierre, SD
educationdirector@sd-discovery.com

Weber, Katie
Turtle Bay Exploration Park
Redding, CA
kweber@turtlebay.org

Wetmore, Jamey
ASU School for the Future of Innov. in Society
Tempe, AZ
Jameson.Wetmore@asu.edu

White, Tifferney
Discovery Place, Inc.
Charlotte, NC
tifferneyw@discoveryplace.org

White, Vivian
Astronomical Society of the Pacific (ASP)
San Francisco, CA
vwhite@astrosociety.org

Whites, Nick
WonderLab Museum of Science, Health
and Tech
Bloomington, IN
educationoutreach@wonderlab.org

Wolfe, Becky
The Children's Museum of Indianapolis
Indianapolis, IN
beckyw@childrensmuseum.org

Woodward, Katie
Discovery Center at Murfree Spring
Murfreesboro, TN
kwoodward@exploredhdc.org

Wouk, Kari
North Carolina Museum of Natural Sciences
Raleigh, NC
kari.wouk@naturalsciences.org

Young, Alex
NASA Goddard Space Flight Center (GSFC)
Greenbelt, MD
c.alex.young@nasa.gov



Participant List

By Region and State

NORTHEAST (NE) REGION

Mestre, David

Discovery Museum and Planetarium
Bridgeport, CT
dmestre@discoverymuseum.org

Pac, Karen

Imagine Nation Children's Museum
Bristol, CT
karen.pac@imaginestation.org

Dione, Donna

Children's Museum of SE CT
Niantic, CT
d.dione@cmsect.org

Kadam, Stephanie

Stepping Stones Museum for Children
Norwalk, CT
stephanie@steppingstonesmuseum.org

Robinson, Ian

The Children's Museum
West Hartford, CT
irobinson@thechildrensmuseumct.org

Hancock, Wendy

Association of Science-Technology Centers
(ASTC)
Washington, DC
whancock@astc.org

Neitzey, Chris

Afterschool Alliance
Washington, DC
cneitzey@afterschoolalliance.org

Perrotto, Cathy

Delaware Museum of Natural History (DMNH)
Wilmington, DE
cperrotto@delmnh.org

Leahey, Elizabeth

The Discovery Museums
Acton, MA
eleahey@discoveryacton.org

Anderson, Allison

Museum of Science, Boston
Boston, MA
aanderson@mos.org

Bell, Larry

Museum of Science, Boston
Boston, MA
lbell@mos.org

Berry, Kayla

Museum of Science, Boston
Boston, MA
kberry@mos.org

Beyer, Marta

Museum of Science, Boston
Boston, MA
mbeyer@mos.org

Heilman, Susan

Museum of Science, Boston
Boston, MA
sheilman@mos.org

Dussault, Mary

Harvard-Smithsonian Center for Astrophysics
Cambridge, MA
mdussault@cfa.harvard.edu

Botelho, Kim

Nantucket Maria Mitchell Association
Nantucket, MA
kbotelho@mariamitchell.org

Beaudry, Louise

South Shore Natural Science Center
Norwell, MA
lbeaudry@ssymca.org

Hale, Lucy

EcoTarium
Worcester, MA
lhale@ecotarium.org

Freund, Brian

Maryland Science Center
Baltimore, MD
bfreund@mdsci.org

Lawton, Brandon

Space Telescope Science Institute (STScI)
Baltimore, MD
lawton@stsci.edu

Rhue, Tim

Space Telescope Science Institute (STScI)
Baltimore, MD
trhue@stsci.edu

Smith, Denise

Space Telescope Science Institute (STScI)
Baltimore, MD
dsmith@stsci.edu

Thompson, Nora

Port Discovery Children's Museum
Baltimore, MD
nthompson@portdiscovery.org

Downey, Meagan

Robinson Nature Center
Columbia, MD
mdowney@howardcountymd.gov

Lottes, Karen

Gaithersburg Community Museum
Gaithersburg, MD
klottes@gaitersburgmd.gov

Mayo, Lou

NASA Goddard Space Flight Center (GSFC)
Greenbelt, MD
Louis.A.Mayo@nasa.gov

Mitchell, Horace

NASA Goddard Space Flight Center (GSFC)
Greenbelt, MD
horace.g.mitchell@nasa.gov

Ng, Carolyn

NASA Goddard Space Flight Center (GSFC)
Greenbelt, MD
carolyn.y.ng@nasa.gov

Young, Alex

NASA Goddard Space Flight Center (GSFC)
Greenbelt, MD
c.alex.young@nasa.gov

Cummings-Rocke, Maizie

Rockville Science Center
Rockville, MD
mc-rocke@juno.com

Plummer, Trudi

Maine Discovery Museum
Bangor, ME
tplummer@mainediscoverymuseum.org

Bate, Jeff

Gulf of Maine Research Institute
Portland, ME
jbate@gmri.org

Lydick, Glenna

SEE Science Center
Manchester, NH
glenna@see-sciencecenter.org

Barracough, Amy

Edelman Planetarium at Rowan University
Glassboro, NJ
barracough@rowan.edu

Kremer, Brian

Liberty Science Center
Jersey City, NJ
bkremer@lsc.org

Conod, Kevin

Newark Museum
Newark, NJ
kconod@newarkmuseum.org

Steinberg, Daniel

Princeton University
Princeton, NJ
dsteinbe@princeton.edu

Gomlak-Green, Sarajane

Buffalo Museum of Science
Buffalo, NY
sgreen@sciencebuff.org

McLaren, Bruce

Regional Science & Discovery Center
Corning, NY
lab@sdscsciencecenter.org

Flynn, Claire

Long Island Children's Museum (LICM)
Garden City, NY
cflynn@licm.org

Kiker, Kerri

Cradle of Aviation Museum
Garden City, NY
kkiker@cradleofaviation.org

Belle, Emily

Sciencenter
Ithaca, NY
ebelle@sciencenter.org

Briere, Dean

Sciencenter
Ithaca, NY
dbriere@sciencenter.org

Jackson, Ali

Sciencenter
Ithaca, NY
ajackson@sciencenter.org

Kortenaar, Michelle

Sciencenter
Ithaca, NY
mkortenaar@sciencenter.org

Emmart, Carter

American Museum of Natural History
New York, NY
carter@amnh.org

Kinzler, Rosamond

American Museum of Natural History
New York, NY
rkinzler@amnh.org

Levine, Brian

American Museum of Natural History
New York, NY
blevine@amnh.org

Reilly, Douglas

AJ Read Science Discovery Center
at SUNY Oneonta
Oneonta, NY
reillydg@oneonta.edu

Uzelmeier, Calvin

Rochester Museum & Science Center (RMSC)
Rochester, NY
cuzelmeier@rmssc.org

Kay, Tracy

Westchester Children's Museum
Rye, NY
tkay@discoverWCM.org

Smith Syden, Sarah

The Children's Museum at Saratoga
Saratoga Springs, NY
executivedirector@cmssny.org

Norris, Megan

miSci Museum of Innovation and Science
Schenectady, NY
megan.norris@misci.org

Gaige, Angela

Milton J. Rubenstein Museum of Science
& Technology (MoST)
Syracuse, NY
agaige@most.org

Baldwin, Dawn

Children's Museum of Science
& Technology (CMOST)
Troy, NY
dbaldwin@cmost.org

Dariento, Michele

Brookhaven National Laboratory's Science
Learning Center
Upton, NY
mdariento@bnl.gov

Bresee, Patricia

Kopernik Observatory & Science Center
Vestal, NY
sbresee@aol.com

Keller, Margaret

Akron Children's Museum
Akron, OH
education@akronkids.org

Downing, Katy

Lake Erie Nature & Science Center
Bay Village, OH
Katyd@lensc.org

Rasnack, Rebecca

Cincinnati Museum Center
Cincinnati, OH
RRasnack@cincymuseum.org

Kaltenbach, Robyn

Great Lakes Science Center
Cleveland, OH
kaltenbachr@glsc.org

Sarver, Josh

Center of Science and Industry (COSI)
Columbus, OH
jsarver@cosi.org

Kuras, Karen

Boonshoft Museum of Discovery
Dayton, OH
kkuras@boonshoftmuseum.org

Bickhart, Erica

Children's Museum of Findlay
Findlay, OH
erica@cmfindlay.com

Garcia, Rachel

SPI Spot
Mount Vernon, OH
RachelSPISpot@gmail.com

LoRaso, Janice

The Works: Ohio Center for History,
Art and Technology
Newark, OH
janicelorasos@attheworks.org

Groft, Tyler

Da Vinci Science Center
Allentown, PA
tyler@davincisciencecenter.org

Daugherty, Breanne

ExpERIENCE Children's Museum
Erie, PA
education@eriechildrensmuseum.org

Smith, Mike

North Museum of Nature and Science
Lancaster, PA
msmith@northmuseum.org

Das, Jayatri

Franklin Institute
Philadelphia, PA
jdas@fi.edu

Pitts, Derrick

Franklin Institute
Philadelphia, PA
dpitts@fi.edu

Hennessy, Mike

Carnegie Science Center
Pittsburgh, PA
HennessyM@CarnegieScienceCenter.org

Perdew, Olivia

Discovery Space of Central Pennsylvania
State College, PA
olivia@mydiscoveryspace.org

Epstein, Bonnie

Rhode Island Museum of Science and Art
(RIMOSA)
Providence, RI
bepstein@rimosa.org

Gamba, Renee
Krupowicz Planetarium
Providence, RI
rgamba@mpsri.net

Smith, Cailee
ECHO Leahy Center for Lake Champlain
Burlington, VT
csmith@echovermont.org

Stafne, Marcos
Montshire Museum of Science
Norwich, VT
marcos.stafne@montshire.org

Nordmann, Leila
Fairbanks Museum and Planetarium
Saint Johnsbury, VT
lnordmann@fairbanksmuseum.org

Martin, Tiffany
Spark! Imagination and Science Center
Morgantown, WV
educator@sparkwv.org

SOUTHEAST (SE) REGION

Cooper, Lawrence
McWane Science Center
Birmingham, AL
lcooper@mcwane.org

Moye, Olivia
Gulf Coast Exploreum Science Center
Mobile, AL
omoye@exploreum.com

Bell, Shawn
Univ of Ark., Center for Math and Science Ed.
Fayetteville, AR
seb010@uark.edu

LaFollette, Diane
Mid-America Science Museum
Hot Springs, AR
dianel@midamericamuseum.org

Kary, Jill
Arkansas State University Museum
Jonesboro, AR
jkary@astate.edu

Gay, Pody
Discovery Network at Museum of Discovery
Little Rock, AR
pgay@museumofdiscovery.org

Kugler, Brittney
Museum of Discovery
Little Rock, AR
bkugler@museumofdiscovery.org

Turner, Sara
IMAG History and Science Center
Fort Myers, FL
sara@theimag.org

Miller, Mary Kate
Golisano Children's Museum of Naples
Naples, FL
weplay@cmn.org

Kmietowicz, Michael
Orlando Science Center
Orlando, FL
mkmietowicz@osc.org

Pratt, Megan
Pensacola MESS Hall
Pensacola, FL
megan.pratt@pensacolamesshall.org

Leavine, Lauren
Great Explorations, The Children's Museum
St. Petersburg, FL
lleavine@greatex.org

Borland, Susan
Challenger Learning Center - Tallahassee
Tallahassee, FL
sborland@challengertlh.fsu.edu

Wadnerkar, Urmila
Museum of Science and Industry (MOSI)
Tampa Bay, FL
urmila.wadnerkar@mosi.org

Pait, Christopher
South Florida Science Center and Aquarium
West Palm Beach, FL
cpait@sfscecenter.org

Arnold, Sarah
Fernbank Museum of Natural History
Atlanta, GA
sarah.arnold@fernbankmuseum.org

Mays, Susan
Museum of Arts and Sciences
Macon, GA
smays@masmacon.com

Bullock, Katherine
Living Arts and Science Center
Lexington, KY
kbullock@lasclex.org

Dixon, Jon
Kentucky Science Center
Louisville, KY
dixonjp@miamioh.edu

Bermudez, Aida
Eastern Kentucky University - Hummel Planetarium
Richmond, KY
aida.bermudez@eku.edu

Talley, Jason
St. Charles Parish Library Planetarium
Luling, LA
jason.talley@myscpl.org

Rabalais, Gillian
Children's Museum of St. Tammany
Manderville, LA
grabalais@cmstkids.org

Brown, Alan
Sci-Port Discovery Center
Shreveport, LA
abrown@sciport.org

Gergeni, Chris
Bayou County Children's Museum
Thibodaux, LA
cgergeni@bccm.info

Norris, Sandra
Lynn Meadows Discovery Center
Gulfport, MS
hehzrsn@cableone.net

Torres, Donna
Infinity Science Center
Pearlington, MS
dortres@visitinfinitum.com

Eakes, Nick
Morehead Planetarium and Science Center
Chapel Hill, NC
neakes@live.unc.edu

Grimm-Vavlitis, Jarrett
Kidzu Children's Museum
Chapel Hill, NC
grimm@kidzuchildrensmuseum.org

Coler, Douglas
Discovery Place, Inc.
Charlotte, NC
DouglasC@discoveryplace.org

White, Tifferney
Discovery Place, Inc.
Charlotte, NC
tifferneyw@discoveryplace.org

Cawley, Max
Museum of Life and Science
Durham, NC
Max.Cawley@LifeandScience.org

Herring, Brad
Museum of Life and Science
Durham, NC
mbradfordherring@gmail.com

Sava, Mitch
Museum of Life and Science
Durham, NC
mitchell.sava@lifeandscience.org

Harrelson, Johlynn
Greensboro Children's Museum
Greensboro, NC
jharrelson@gcmuseum.com

Regester, Martha
Greensboro Science Center
Greensboro, NC
mregester@greensboroscience.org

Spinks, Kellie
Hands On! Children's Museum
Hendersonville, NC
kellie@handsonwnc.org

Beery, Nicolas
Beery Media, LLC
Hillsborough, NC
nic@beerymedia.com

Ken, Brandt
Robeson Planetarium and Science Center
Lumberton, NC
brandt@uncp.edu

Engelhardt, Hardin
Marbles Kids Museum
Raleigh, NC
engelhardt@marbleskidsmuseum.org

Wouk, Kari
North Carolina Museum of Natural Sciences
Raleigh, NC
kari.wouk@naturalsciences.org

Hunt, Katherine
Ingram Planetarium, Museum of Coastal Carolina
Sunset Beach, NC
katherine@museumplanetarium.org

Thornton, Amy
Cape Fear Museum
Wilmington, NC
athornton@ncgov.com

Turman, Lori
Oklahoma Wondertorium
Stillwater, OK
lori.turman@okwondertorium.org

Blansett, Tonya
Tulsa Air & Space Museum & Planetarium
Tulsa, OK
tblansett@tulsamuseum.org

Nail, Dustyn
Discovery Lab
Tulsa, OK
dnail@discoverylab.org

Vandiver, Ray
Discovery Lab
Tulsa, OK
rvandiver@discoverylab.org

Santiago, Sujeily
Arecibo Observatory - Angel Ramos Foundation Visitor Center
Arecibo, PR
sujeily.santiago@naic.edu

Riddle, Thomas
Roper Mountain Science Center
Greenville, SC
triddle@greenville.k12.sc.us

Rinehart, Caroline
The Sandbox Children's Museum
Hilton Head Island, SC
crinehart@thesandbox.org

Holmberg, Carole
Museum of York County
Rock Hill, SC
CHolmberg@chmuseums.org

Scott, Lucien
Creative Discovery Museum
Chattanooga, TN
lgs@cdmfun.org

Laurence, Nancy
The Muse Knoxville
Knoxville, TN
nancy@themuseknoxville.org

Eilers, Alex
Pink Palace Museum
Memphis, TN
Alex.Eilers@memphistn.gov

Woodward, Katie
Discovery Center at Murfree Spring
Murfreesboro, TN
kwoodward@exploredhdc.org

Criss, Lacey
Adventure Science Center
Nashville, TN
lcriss@adventuresci.org

Orr, Russell
Discovery Park of America
Union City, TN
ROrr@discoveryparkofamerica.com

Ried, Mandi
Don Harrington Discovery Center
Amarillo, TX
mandi@dhdc.org

Hill, Ashley
Thinkery
Austin, TX
ahill@thinkeryaustin.org

Pena, Felipe
Children's Museum of Brownsville
Brownsville, TX
felipe@cmofbrownsville.com

Garza, Mary Jane
Corpus Christi Museum of Science and History
Corpus Christi, TX
DrMJ@ccmuseum.com

Liken, Jessica
Perot Museum of Nature and Science
Dallas, TX
jessica.likan@perotmuseum.org

Curry, Meghan
Insights El Paso Science Center
El Paso, TX
meg@insightselpaso.org

Santana, Anne
Fort Worth Museum of Science and History
Fort Worth, TX
asantana@fwmsrh.org

Pielli, Sloane
Sci-Tech Discovery Center
Frisco, TX
sloane.pielli@scitechdiscovery.org

Hammond, Jason
Children's Museum of Houston
Houston, TX
jhammond@cmhouston.org

Ostfeld, Keith
Children's Museum of Houston
Houston, TX
kto@cmhouston.org

Shupla, Christine
Lunar and Planetary Institute (LPI)
Houston, TX
shupla@lpi.usra.edu

Cavazos, Sandra
Imaginarium of South Texas
Laredo, TX
scavazos@imaginariumstx.org

Baliga, Alana
Science Spectrum
Lubbock, TX
alana@sciencespectrum.org

Ortega, Carmen
The Woodlands Children's Museum
The Woodlands, TX
cortega@woodlandschildrensmuseum.org

Rasure, Chris
Discovery Science Place
Tyler, TX
crasure@uttyler.edu

Miller, Sarah
Mayborn Museum Complex
Waco, TX
sarah_c_miller@baylor.edu

Low, Rusty
Institute for Global Environmental
Strategies (IGES)
Arlington, VA
rusty_low@strategies.org

Rehkamp, Jennifer
Association of Children's Museums (ACM)
Arlington, VA
jennifer.rehkamp@childrensmuseums.org

Schwerin, Theresa
Institute for Global Environmental
Strategies (IGES)
Arlington, VA
theresa_schwerin@strategies.org

Buchanan, Brian
Danville Science Center
Danville, VA
bbuchanan@smv.org

Chalasani, Laahiri
Children's Science Center
Fairfax, VA
laahirichalasani@childsci.org

Chambers, Lin
NASA Langley Research Center
Hampton, VA
lin.h.chambers@nasa.gov

Harper-Neely, Joan
National Institute of Aerospace
Hampton, VA
joan.harper-neely@nianet.org

Harte, Tina
NASA Langley Research Center
Hampton, VA
tina.r.harte@nasa.gov

Taylor, Jessica
NASA Langley Research Center
Hampton, VA
jessica.e.taylor@nasa.gov

Matyseck, Christyne
Children's Museum of VA - Portsmouth
Museums
Portsmouth, VA
matyseckc@portsmouthva.gov

Needs, Sarah
NASA Wallops Flight Facility
Wallops Island, VA
sarah.j.needs@nasa.gov

Schnoor, Diane
Shenandoah Valley Discovery Museum
Winchester, VA
dianejacksonschnoor@gmail.com

MIDWEST (MW) REGION

Kannenberg, Jared
Family Museum of Arts and Science
Bettendorf, IA
jkannenberg@bettendorf.org

Schwanebeck, Allison
Science Center of Iowa
Des Moines, IA
allison.schwanebeck@sciowa.org

Peralez, Megan
SciTech Hands On Museum
Aurora, IL
megan.scitech@gmail.com

Dour, Alex
Orpheum Children's Museum
Champaign, IL
education@orpheumkids.com

Dreiling, Dillon
Museum of Science and Industry (MSI)
Chicago, IL
dillon.dreiling@msichicago.org

Carpenter, Rachel
Children's Discovery Museum
Normal, IL
rcarpenter@normal.org

Hendrickson, Heather
Children's Museum in Oak Lawn
Oak Lawn, IL
heather@cmoaklawn.org

Lessen, Shelby
Peoria Riverfront Museum
Peoria, IL
slessen@peoriariverfrontmuseum.org

Rathbun, Michael
Discovery Center Museum
Rockford, IL
michaelr@discoverycentermuseum.org

Whites, Nick
WonderLab Museum of Science,
Health and Tech
Bloomington, IN
educationoutreach@wonderlab.org

Burkhart, Katie (Kat)
Carnegie Museum of Montgomery County
Crawfordsville, IN
carnegie@cdpl.lib.in.us

Wolfe, Becky
The Children's Museum of Indianapolis
Indianapolis, IN
beckyw@childrensmuseum.org

Paul, Marcy
Muncie Children's Museum
Muncie, IN
mpaul@munciemuseum.com

Luttjohann, Caitlin
Kansas Children's Discovery Center
Topeka, KS
cluttjohann@kansasdiscovery.org

Gilmartin, Victoria
Exploration Place
Wichita, KS
victoria.gilmartin@exploration.org

Heisler, Etta
Ann Arbor Hands On Museum (AAHOM)
Ann Arbor, MI
etta@lesliesnc.org

Gibson, Charles
Michigan Science Center
Detroit, MI
Charles.Gibson@mi-sci.org

Ogren, Stephanie
Grand Rapids Public Museum
Grand Rapids, MI
sogren@grpm.org

Godin, Kathy
Kalamazoo Valley Museum
Kalamazoo, MI
kgodin@kvcc.edu

Hill, Matt
Impression 5 Science Center
Lansing, MI
hill@impression5.org

Drake, Anne
Great Lakes Children's Museum
Traverse City, MI
adrake@glcm.org

Owens, James
Headwaters Science Center
Bemidji, MN
riverhom@paulbunyan.net

Taylor, Anika
The Bakken Museum
Minneapolis, MN
taylor@thebakken.org

Gordon, John
Science Museum of Minnesota
Saint Paul, MN
jgordon@smm.org

King, Zdanna
Science Museum of Minnesota
Saint Paul, MN
zking@smm.org

Kruszka, Ethan
Science Museum of Minnesota
Saint Paul, MN
ekruszka@smm.org

Leavell, Christina
Science Museum of Minnesota
Saint Paul, MN
cleavell@smm.org

Long, Steph
Science Museum of Minnesota
Saint Paul, MN
slong@smm.org

McCarthy, Catherine
Science Museum of Minnesota
Saint Paul, MN
cmccarthy@smm.org

Phan, Brandon
Science Museum of Minnesota
Saint Paul, MN
bphan@smm.org

Velazquez, Hever
Science Museum of Minnesota
Saint Paul, MN
hvelazquez@smm.org

McConnell, Michael
Science City at Union Station
Kansas City, MO
mmcconnell@unionstation.org

Heck, Jacob
Bootheel Youth Museum
Malden, MO
jacobheck01@bootheelyouthmuseum.org

Freiling, Paul
Saint Louis Science Center
Saint Louis, MO
paul.freiling@slsc.org

Stoltz, Courtney
Gateway to Science
Bismarck, ND
courtney@gscience.org

Bartlett, Lindsay
Lincoln Children's Museum
Lincoln, NE
lbartlett@lincolnchildrensmuseum.org

Janovec, Terese
Nebraska Center for Materials
and Nanoscience
Lincoln, NE
tjanovec3@unl.edu

Waldman, Rhea
South Dakota Discovery Center
Pierre, SD
educationdirector@sd-discovery.com

Isaacson, Jenna
Washington Pavilion, Kirby Science
Discovery Center
Sioux Falls, SD
jisaacson@washingtonpavilion.org

Couillard, Carol
Paper Discovery Center
Appleton, WI
Carol@paperdiscoverycenter.org

Julsrud, Katie
Children's Museum of Eau Claire
Eau Claire, WI
katie@childrensmuseumec.com

Anderson, Gina
The Children's Museum of Green Bay
Green Bay, WI
ganderson@gbchildrensmuseum.org

Karlen, Kia
Madison Children's Museum
Madison, WI
kkarlen@madisonchildrensmuseum.org

Pariso, Bill
Betty Brinn Children's Museum
Milwaukee, WI
bpariso@bbcmkids.org

Murray, Meghan
Above & Beyond Children's Museum
Sheboygan, WI
meghan@abkids.org

WESTERN (W) REGION

Slonecker, Aaron
Anchorage Museum
Anchorage, AK
aslonecker@anchagemuseum.org

Arseneau, Jennifer
University of Alaska Museum of the North
Fairbanks, AK
j.arseneau@alaska.edu

Farr, Jessica
Fairbanks Children's Museum
Fairbanks, AK
jessica@fairbankschildrensmuseum.com

Diamond, Teri
Challenger Learning Center of Alaska
Kenai, AK
teri.diamond@akchallenger.org

Greene, Melanie
Bisbee Science Exploration
& Research Center
Bisbee, AZ
melanie@mgreenepd.com

Mannis, Kal
Rural Activation and Innovation Network
Bisbee, AZ
mrkmannis@gmail.com

Rubino-Hare, Lori
Northern Arizona University
Flagstaff, AZ
Lori.Hare@nau.edu

Custer, Sari
Arizona Science Center
Phoenix, AZ
custers@azscience.org

Thomas, Kamlynn
Arizona Science Center
Phoenix, AZ
thomask@azscience.org

Anbar, Ariel
ASU School of Earth and Space Exploration
Tempe, AZ
anbar@asu.edu

Ash, Deron
ASU School for the Future of Innov. in Society
Tempe, AZ
deron.ash@asu.edu

Bell, Jim
ASU School of Earth and Space Exploration
Tempe, AZ
Jim.Bell@asu.edu

Bennett, Ira
ASU School for the Future of Innov. in Society
Tempe, AZ
ira.bennett@asu.edu

Colton, Jeannie
ASU School for the Future of Innov. in Society
Tempe, AZ
jeannie.colton@asu.edu

Elkins-Tanton, Lindy
ASU School of Earth and Space Exploration
Tempe, AZ
lclkinst@asu.edu

Finn, Edward
Center for Science and the Imagination
Tempe, AZ
edfinn@asu.edu

Guston, David
ASU School for the Future of Innov. in Society
Tempe, AZ
david.guston@asu.edu

Kirk, Sina
ASU School of Earth and Space Exploration
Tempe, AZ
Sina.Kirk@asu.edu

Martin, Paul
ASU School for the Future of Innov. in Society
Tempe, AZ
paulmartin@asu.edu

Ostman, Rae
ASU School for the Future of Innov. in Society
Tempe, AZ
rostman@asu.edu

Smas, Scott
ASU School of Earth and Space Exploration
Tempe, AZ
Scott.Smas@asu.edu

Swann, Jessica
ASU School of Earth and Space Exploration
Tempe, AZ
jlswann@asu.edu

Tamer, Joe
ASU School of Earth and Space Exploration
Tempe, AZ
atamer@asu.edu

Wetmore, Jamey
ASU School for the Future of Innov. in Society
Tempe, AZ
Jameson.Wetmore@asu.edu

Rushin Irr, Melissa
Children's Museum of Yuma County
Yuma, AZ
melissa@yumachildrensmuseum.com

Bailey, Melinda
Humboldt State University Natural History Museum (HSU)
Arcata, CA
mjb11@humboldt.edu

Kusiak, Frank
Lawrence Hall of Science
Berkeley, CA
frank_kusiak@berkeley.edu

Perry, Dustin
Lawrence Hall of Science
Berkeley, CA
dustin.perry@berkeley.edu

Valencia, Sandra
Columbia Memorial Space Center
Downey, CA
svalencia@downeyspacecenter.org

Lee, Amanda
San Diego Children's Discovery Museum
Escondido, CA
amandal@sdcdm.org

Telemeco, Melissa
Fresno State, Downing Planetarium
Fresno, CA
mtelemeco@csufresno.edu

Juarez, Juanita
California Science Center
Los Angeles, CA
jjuaraz@cscmail.org

Day, Brian H.
NASA Solar System Exploration Research Virtual Institute
Moffett Field, CA
Brian.H.Day@nasa.gov

Harman, Pamela
SETI Institute
Mountain View, CA
pharman@seti.org

Hoover, Lisa
Chabot Space & Science Center
Oakland, CA
lhoover@chabotspace.org

Chapman, Amelia
NASA Jet Propulsion Laboratory (JPL)
Pasadena, CA
amelia.j.chapman@jpl.nasa.gov

Craig, Jason
NASA Jet Propulsion Laboratory (JPL)
Pasadena, CA
jason.s.craig@jpl.nasa.gov

Ferrari, Kay
NASA Jet Propulsion Laboratory (JPL)
Pasadena, CA
kay.a.ferrari@jpl.nasa.gov

Law, Emily
NASA Jet Propulsion Laboratory (JPL)
Pasadena, CA
emily.s.law@jpl.nasa.gov

Weber, Katie
Turtle Bay Exploration Park
Redding, CA
kweber@turtlebay.org

Peticolas, Laura
Sonoma State University
Rohnert Park, CA
laurap@universe.sonoma.edu

Montgomery, Sheila
Powerhouse Science Center
Sacramento, CA
smontgomery@powerhousesc.org

Pebdani, Andia
Fleet Science Center
San Diego, CA
publicprograms@rhfleet.org

Bartolone, Lindsay
Children's Creativity Museum
San Francisco, CA
lindsaybartolone@gmail.com

Hurst, Anna
Astronomical Society of the Pacific (ASP)
San Francisco, CA
ahurst@astrosociety.org

Kornei, Kathy
Children's Creativity Museum
San Francisco, CA
hobbies4kk@gmail.com

Porcello, Darrell
Children's Creativity Museum
San Francisco, CA
porcello@berkeley.edu

Roberts, Michael
Morrison Planetarium
San Francisco, CA
mroberts@calacademy.org

Shore, Linda
Astronomical Society of the Pacific (ASP)
San Francisco, CA
lshore@astrosociety.org

White, Vivian
Astronomical Society of the Pacific (ASP)
San Francisco, CA
vwhite@astrosociety.org

Forsyth, Stacey
CU Science Discovery,
Univ Colorado Boulder
Boulder, CO
stacey.forsyth@colorado.edu

Harold, James
Space Science Institute (SSI)
Boulder, CO
harold@SpaceScience.org

Holland, Anne
Space Science Institute (SSI)
Boulder, CO
aholland@spacescience.org

LaConte, Keliann
Space Science Institute (SSI)
Boulder, CO
klaconte@spacescience.org

Sands, Samantha
Denver Museum of Nature & Science
Denver, CO
Samantha.Sands@dmns.org

Ivanovich, Donitza
Powerhouse Science Center
Durango, CO
donitza@powsci.org

Unger, Beth
Fort Collins Museum of Discovery
Fort Collins, CO
bunger@fcmmod.org

Andersen, Hadley
Bishop Museum
Honolulu, HI
hadley.andersen@gmail.com

Beswick, Margaret
Hawaii Children's Discovery Center
Honolulu, HI
margo@discoverycenterhawaii.org

Murta, Rimma
Maui Science Center
Kihei, HI
rimma@mauisciencecenter.com

Burke, Jessica
Discovery Center of Idaho
Boise, ID
j.burke@dcidaho.org

Doucette, Chloe
Museum of Idaho
Idaho Falls, ID
education@museumofidaho.org

Jones, Virginia
Idaho Museum of Natural History
Pocatello, ID
jonevir2@isu.edu

Toohill, Kelli
Wise Wonders Children's Museum
Billings, MT
ktoohill@wisewonders.org

Taylor, Suzi
Montana State University
Bozeman, MT
taylor@montana.edu

Feilzer, Sara
Exploration Works!
Helena, MT
saraf@explorationworks.org

Ervin, Caitlin
spectrUM Discovery Area
Missoula, MT
caitlin.ervin@umontana.edu

Dooling, Dave
New Mexico Museum of Space History
Alamogordo, NM
dave.dooling@state.nm.us

Dilley, Kevin
Explora Science Museum
Albuquerque, NM
kdilley@explora.us

Kohl, Holli
NASA Goddard Space Flight Center (SSAI)
Albuquerque, NM
holli.kohl@nasa.gov

Novak, Deb
New Mexico Museum of Natural History
Albuquerque, NM
deb.novak@state.nm.us

Powell, Cherie
E3 Children's Museum & Science Center
Farmington, NM
cpowell@fmrtn.org

Dresher, Pamela
Bradbury Science Museum
Los Alamos, NM
padresher@lanl.gov

Nicholson, Amanda
Roswell Museum and Art Center
Roswell, NM
a.nicholson@roswell-nm.gov

Christian, Laura
Discovery Children's Museum
Las Vegas, NV
LChristian@discoverykidslv.org

Schiedel, Meghan
Terry Lee Wells Nevada Discovery Museum
Reno, NV
mschiedel@nvdm.org

Ruby, Dan
ScienceWorks Hands-On Museum
Ashland, OR
dan@scienceworksmuseum.org

Knecht, Karyn
Eugene Science Center
Eugene, OR
kknecht@sciencefactory.org

Benne, Marcie
Oregon Museum of Science and Industry (OMSI)
Portland, OR
mbenne@omsi.edu

Maletz, Emily
Emily Maletz Graphic Design
Portland, OR
emily@emilymaletz.com

Rooney, Sean
Oregon Museum of Science and Industry (OMSI)
Portland, OR
srooney@omsi.edu

Clouse, Ashley
Thanksgiving Point Institute
Lehi, UT
aclouse@thanksgivingpoint.org

Cunningham, Chris
KidsQuest Children's Museum
Bellevue, WA
chris@kidsquestmuseum.org

Spicher, Nick
Imagine Children's Museum
Everett, WA
NickS@imaginecm.org

Hogeboom, Erin
National Girls Collaborative Project
Lynwood, WA
ehogeboom@ngcproject.org

Mealy, Tedrick
Northwest Earth and Space Sciences Pipeline
Seattle, WA
mealyt@uw.edu

Milliron, Jake
Mobius Spokane
Spokane, WA
jmilliron@mobiusspokane.org

DeVoss, Shelly
The Science Zone
Casper, WY
Shelly.Devoss@thesciencezone.org

Minard, Reena
Lander Children's Museum
Lander, WY
landerchildrensmuseum@gmail.com

Thank You

We would like to extend our thanks to all meeting participants for taking part in the gathering. We're delighted to have so many partners and collaborators join us from the NISE Network, NASA SMD Science Activation, and Arizona State University. We would also like to acknowledge the ongoing support of the NASA Science Mission Directorate, particularly our technical officer, Kristen Erickson.

The NISE Network Earth & Space project leadership team:

Paul Martin

Principal investigator
Arizona State University

Deron Ash

Project administration
Arizona State University

Larry Bell

Co-investigator
Museum of Science

Kayla Berry

Project administration
Museum of Science

Brad Herring

Workgroup leader and regional hub leader
Museum of Life and Science

Ali Jackson

Workgroup leader and regional hub leader
Sciencenter

Liz Kollmann

Workgroup leader
Museum of Science

Frank Kusiak

Regional hub leader
Lawrence Hall of Science

Christina Leavell

Regional hub leader
Science Museum of Minnesota

Catherine McCarthy

Co-investigator
Science Museum of Minnesota

Rae Ostman

Co-investigator
Arizona State University

Darrell Porcello

Co-investigator
Children's Creativity Museum



